

Copper Tubular Cable Lugs -40C~+105C Terminal Lug High Current Cable Lug 95-150mm²

Our Product Introduction

for more products please visit us on cableslugs.com

Basic Information

- Place of Origin: China
- Brand Name: TLC
- Certification: UL, CUL, CE
- Model Number: SC
- Minimum Order Quantity: 1000 pcs
- Price: USD
- Packaging Details: Carton
- Delivery Time: 5-30 days
- Payment Terms: T/T
- Supply Ability: 500 - 1000 K PCS



Product Specification

- Material: Copper
- Tin Plated: Yes
- Temperature Range: -40 ~+105
- Color: Silver
- Cable Range: 0.5-300mm²
- Direction: 180D, 45D, 90D, 135D
- Highlight: **Copper Tubular Cable Lugs -40C,**
Copper Tubular Cable Lugs +105C,
electrical cable lugs 150mm²



Product Description



Non- Insulated - Copper Lugs

SC LUGS TERMINALS

Material
Terminal Body: Copper
Plating: Tin

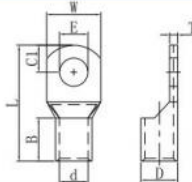

WIRE RANGE	STUD SIZE		ITEM NO	DIMENSION mm								P/N	QTY BOX
	mm2 (A.W.G)	Metric		Amerian	E	D	d	W	B	C1	L		
95 (3/0)	6	1/4	SC95-6	6.4	17.4	13.5	25.5	23.0	12.5	58.0	3.8	T-12131168	30
	8	5/16	SC95 - 8	8.4								T-12131169	
	10	3/8	SC95 - 10	10.5								T-12131170	
	12	1/2	SC95 - 12	13.0								T-12131171	
	14	9/16	SC95 - 14	15.0								T-12131172	
95 (3/0)	6	1/4	SC95-6-GTNR	6.4	18.0	14.0	26.0	20.0	13.0	55.0	4.0	T-12131173	30
	8	5/16	SC95 - 8-GTNR	8.4								T-12131174	
	10	3/8	SC95 - 10-GTNR	10.5								T-12131175	
	12	1/2	SC95 - 12-GTNR	13.0								T-12131176	
120 (4/0)	6	1/4	SC120-6	6.4	19.5	15.0	28.0	22.0	15.0	63.0	4.4	T-12131177	30
	8	5/16	SC120- 8	8.4								T-12131178	
	10	3/8	SC120 - 10	10.5								T-12131179	
	12	1/2	SC120 - 12	13.0								T-12131180	
	14	9/16	SC120 - 14	15.0								T-12131181	
	16	5/8	SC120 - 16	17.0								T-12131182	
150 (4/0)	6	1/4	SC150-6	6.4	23.0	18.0	32.5	26.0	15.5	68.5	5.0	T-12131187	30
	8	5/16	SC150- 8	8.4								T-12131188	
	10	3/8	SC150 - 10	10.5								T-12131189	
	12	1/2	SC150 - 12	13.0								T-12131190	
	14	9/16	SC150 - 14	15.0								T-12131191	
	16	5/8	SC150 - 16	15.0								T-12131192	

TLC TERMINALS INC.
Terminals

113

Product Description:

Lugs terminals are necessary components in electric systems, which can offer solid and dependable connections between wires, cables, and electric devices or equipment. The correct installation of these parts is crucial for the best electrical operation and safety.

Features:

The combination of **lugs and terminals** guarantee a stable electrical connection. It is very important for the optimal transmission of electrical power or signals between devices.

Installing *lugs and terminals* appropriately avoids any loose connections and prevents bad performance, excessive heat, or even electrical failures.

Applications:

Lugs Terminals: Essential Connectors

Lugs terminals are essential components in electrical systems. They provide a dependable connection between wires or cables and various electrical devices or equipment.

These small metal pieces come in various sizes and shapes to suit different wire gauges and terminal types. Most lugs

are made of copper or aluminum, and they are either crimped or soldered to the ends of the wires. The crimping process helps to ensure that the connection is secure and reliable.

Once installed, lugs terminals provide a secure and reliable connection that helps to protect the safety of electrical systems and the people using them. They play an important role in helping to ensure the reliability of electrical equipment and the power flow in electrical systems.

Support and Services:

Our company provides technical support and services for Tubular Cable Lugs. We offer pre-sales support, installation instructions, and after-sales support.

Pre-sales support includes technical advice on product selection, product specifications, and pricing.

Installation instructions are provided to ensure the proper installation of Tubular Cable Lugs and to guide customers through the installation process.

After-sales support includes troubleshooting, maintenance, and replacement services.

We are committed to providing quality technical support and services to ensure our customer's satisfaction.

Packing and Shipping:

Tubular Cable Lugs are typically packaged in boxes or on reels. The boxes should be clearly labeled with the part number, the manufacturer's name and address, and the quantity. The reels should be clearly labeled with the part number, the manufacturer's name and address, and the weight.

Shipping of Tubular Cable Lugs is typically done by ground or air freight. Ground freight should be used when the quantity is large and the destination is close. Air freight should be used when the quantity is small and the destination is farther away.

When shipping Tubular Cable Lugs, it is important to use the right packaging materials and to ensure that the product is secure. The boxes should be made of strong cardboard and the reels should be wrapped in bubble wrap or other protective material. The package should also include a packing list that outlines the contents of the package and the quantity.

FAQ:

Q1: What is the brand name of Tubular Cable Lugs?

A1: The brand name of Tubular Cable Lugs is TLC.

Q2: What is the model number of Tubular Cable Lugs?

A2: The model number of Tubular Cable Lugs is SC.

Q3: Where is the place of origin of Tubular Cable Lugs?

A3: The place of origin of Tubular Cable Lugs is China.

Q4: What certifications does Tubular Cable Lugs have?

A4: Tubular Cable Lugs has UL, CUL, CE certifications.

Q5: What is the minimum order quantity of Tubular Cable Lugs?

A5: The minimum order quantity of Tubular Cable Lugs is 1000 pcs.



TLC TERMINALS TECHNOLOGY LIMITED



+8615338876153



joe@t-terminals.com



cableslugs.com

4B Huafeng Industrial Park Baolong 1 Road Baolong Street, Longgang District, Shenzhen City