

Temperature Range -40C~+105C Terminal Lugs For 150-300mm² Terminal Cable Lug

Our Product Introduction

Basic Information

- Place of Origin: China
- Brand Name: TLC
- Certification: UL, CUL, CE
- Model Number: SC
- Minimum Order Quantity: 1000 pcs
- Price: USD
- Packaging Details: Carton
- Delivery Time: 5-30 days
- Payment Terms: T/T
- Supply Ability: 500 - 1000 K PCS



Product Specification

- Material: Copper
- Tin Plated: Yes
- Color: Silver
- Temperature Range: -40 ~+105
- Direction: 180D, 45D, 90D, 135D
- Cable Range: 0.5-300mm²
- Highlight: **Temperature Range -40C Tubular Cable Lugs, Tubular Cable Lugs +105C, 300mm² Terminal Cable Lug**



for more products please visit us on cableslugs.com

Product Description



Non- Insulated - Copper Lugs

SC LUGS TERMINALS

Material
Terminal Body: Copper
Plating: Tin

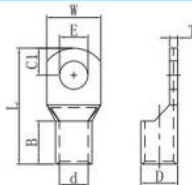

WIRE RANGE	STUD SIZE		ITEM NO	DIMENSION mm								P/N	QTY BOX
	mm2 (A.W.G)	Metric	Amerian	E	D	d	W	B	C1	L	T		
185 (300/350)	10	3/8		SC185 - 10	10.5							T-12131193	10
	12	1/2		SC185 - 12	13.0							T-12131194	
	14	9/16		SC185 - 14	15.0							T-12131195	
	16	5/8		SC185 - 16	15.0							T-12131196	
240 (400/450)	10	3/8		SC240 - 10	10.5							T-12131197	5
	12	1/2		SC240 - 12	13.0							T-12131198	
	14	9/16		SC240 - 14	16.0	27.0	21.0	38.2	37.8	18.8	90.0	T-12131199	
	16	5/8		SC240 - 16	17.0							T-12131200	
	20	3/4		SC240 - 20	21.0							T-12131201	
300 (500)	10	3/8		SC300 - 10	10.5							T-12131202	5
	12	1/2		SC300 - 12	13.0							T-12131203	
	14	9/16		SC300 - 14	16.0	30.0	23.5	43.5	42.5	19.8	97.5	T-12131204	
	16	5/8		SC300 - 16	17.0							T-12131205	
	20	3/4		SC300 - 20	21.0							T-12131206	

Product Description:

Lugs Terminals

Lugs terminals are essential components in electrical systems, which promote the security and reliability of connections between wires, cables and electrical equipment. Accordingly, its obligation installation is paramount for the best performance of the electrical system and for fulfilling safety requirements.

Lugs provide a sophisticated way to interconnect electrical devices, accompanied by crimp technology to offer over-test performance and dependable electrical integrity even in the most harsh environment.

In older systems lugs were also used to attach electrical cables to switches and outlets that determined more efficient electrical connection. Nowadays lugs are available in a broad variety of designs, including insulated terminals, closed-bars, eyelets and many more, that facilitate adaptability to diverse situation and preferences.

Features:

The combination of lugs and terminals provides a reliable and robust electrical connection. This is essential for the competent transfer of electricity or signals among appliances. Secured fitting lugs and terminals are capable of stopping unsteady links, which can potentially cause glitches, an exaggerated temperature level, or even power collapse.

Applications:

Lug terminals are a crucial component of electrical systems, responsible for connecting wires or cables to various devices or equipment. These terminals are small metal connectors that can either be crimped or soldered onto the ends of wires. What's so convenient about lugs is the wide range of size and shape. Depending on your situation, you can find lugs to fit various wire gauges and terminal types. So, regardless of your preferred setup, you can trust lug terminals to provide a secure and reliable connection.

Support and Services:

We provide technical support and service for our Tubular Cable Lugs. Our team of experienced professionals are available to answer any technical questions you might have about the product and its installation process. We also provide ongoing technical support and maintenance to ensure your Tubular Cable Lugs remain in good working order. Additionally, we offer free lifetime repair and replacement services for any faulty parts.

Packing and Shipping:

Tubular cable lugs are packaged in strong, durable boxes that provide protection from dust and moisture. The boxes are labeled with the product name and code, and can hold up to 5,000 lugs per box. All boxes are sealed for extra protection and are designed to withstand the rigors of shipping and storage.

Tubular cable lugs are shipped via ground delivery, usually on the same day the order is placed. We use national carriers such as UPS and FedEx for fast and reliable delivery. We also offer international shipping for customers outside the United States.

FAQ:

Q: What is the brand name of Tubular Cable Lugs?

A: The brand name of Tubular Cable Lugs is TLC.

Q: What is the model number of Tubular Cable Lugs?

A: The model number of Tubular Cable Lugs is SC.

Q: Where is Tubular Cable Lugs manufactured?

A: Tubular Cable Lugs is manufactured in China.

Q: Is Tubular Cable Lugs certified?

A: Yes, Tubular Cable Lugs is certified by UL, CUL, and CE.

Q: What is the minimum order quantity of Tubular Cable Lugs?

A: The minimum order quantity of Tubular Cable Lugs is 1000 pcs.



TLC TERMINALS TECHNOLOGY LIMITED



+8615338876153



joe@t-terminals.com



cableslugs.com

4B Huafeng Industrial Park Baolong 1 Road Baolong Street, Longgang District, Shenzhen City