

Copper Ring Cable Lugs For Electrical Connections And Terminations 0.5-6mm²

Our Product Introduction

for more products please visit us on cableslugs.com

Basic Information

- Place of Origin: China
- Brand Name: TLC
- Certification: UL, CUL, CE
- Model Number: RNB
- Minimum Order Quantity: 1000
- Price: USD
- Packaging Details: bag, carton package
- Delivery Time: 5-30 working days
- Payment Terms: T/T
- Supply Ability: 1KK pcs per month



Product Specification

- Brand: TLC
- Finish: Tin Plated
- Shape: Ring
- Material: Copper
- Type: Cable Lugs
- Product Name: Ring Cable Lugs
- Temperature Range: -40°C To +105°C
- Application: Electrical Connections
- Highlight: 0.5mm² Copper Ring Cable Lug tlc,
0.5mm² Electrical Connection Ring Cable Lugs tlc
, 0.5mm² copper ring type lugs tlc



Non-Insulated with Brazed Seam

RING TERMINALS

Material
Terminal Body: Copper
Plating: Tin

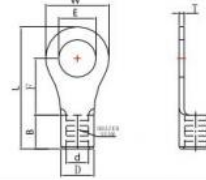

WIRE RANGE	STUD SIZE		ITEM NO	DIMENSION mm								P/N	QTY BOX
				E	W	F	L	B	D	d	T		
0.5-15 (22-16)	3	#4	RNB1-3.2	3.2								T-12091801	1000
	3.5	#6	RNBS1-3.7		5.5	5.0	12.5					T-12091802	
	3.5	#6	RNBM1-3.7	3.7	6.6	6.3	14.4					T-12091803	
	3.5	#6	RNBL1-3.7		8.0	7.0	15.8					T-12091804	
	4	#8	RNBS1-4	4.3	6.6	6.3	14.4					T-12091805	
	4	#8	RNBL1-4		8.0	7.0	15.8					T-12091806	
	5	#10	RNBS1-5	5.3							0.75	T-12091807	
	5	#10	RNBL1-5		9.5	7.0	17.5	4.8	3.4	1.7		T-12091808	
	6	1/4"	RNBS1-6	6.4								T-12091809	
	6	1/4"	RNBL1-6		11.6	11.0	21.8					T-12091810	
	8	5/16"	RNB1-8	8.4								T-12091811	
	10	3/8"	RNB1-10	10.5	13.6	13.9	25.5					T-12091812	
	12	1/2"	RNB1-12	13.0	19.2	16.0	30.4					T-12091813	
	14	9/16"	RNB1-14	15.0								T-12091814	
	16	5/8"	RNB1-16	17.0	27.0	21.0	39.3				0.8	T-12091815	
	20	3/4"	RNB1-20	21.0								T-12091816	
1.5-2.5 (16-14)	3	#4	RNB2-3.2	3.2								T-12091817	
	3.5	#6	RNBS2-3.7		6.6	4.8	12.8					T-12091818	
	3.5	#6	RNBM2-3.7	3.7		6.3	14.4	4.8	4.1	2.3	0.8	T-12091819	
	3.5	#6	RNBL2-3.7		8.5	7.4	16.5					T-12091820	
	4	#8	RNBS2-4	4.3	6.6	6.3	14.4					T-12091821	

RING TERMINALS

Material
Terminal Body: Copper
Plating: Tin

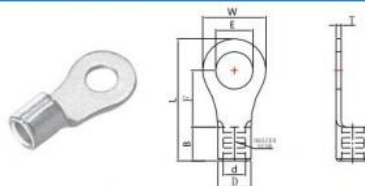

WIRE RANGE	STUD SIZE		ITEM NO	DIMENSION mm								P/N	QTY BOX
	mm2 (A.W.G)	Metric		American	E	W	F	L	B	D	d		
1.5-2.5 (16-14)	4	#8	RNBL2-4	4.3	8.5	7.4	16.5	4.8	4.1	2.3	0.8	T-12091822	
	5	#10	RNBS2-5	5.3								T-12091823	
	5	#10	RNBL2-5									T-12091824	
	6	1/4"	RNB2-6	6.4	12.0	11.0	21.8					T-12091825	
	8	5/16"	RNB2-8	8.4	12.0	11.0	21.8					T-12091826	
	10	3/8"	RNB2-10	10.5	13.6	13.9	25.5					T-12091827	
	12	1/2"	RNB2-12	13.0	19.2	16.0	30.4					T-12091828	
	14	9/16"	RNB2-14	15.0	27.0	21.0	39.3					T-12091829	
	16	5/16"	RNB2-16	17.0								T-12091830	
	20	3/4"	RNB2-20	21.0								T-12091831	
2.5-4 (14-12)	4	#8	RNB3-4	4.3	8.0	8.0	18.0	6.0	5.1	2.9	1.0	T-12091832	1000
	5	#10	RNB3-5	5.3								T-12091833	
	5	#10	RNBL3-5		12.0	9.4	21.4					T-12091834	
	6	1/4"	RNB3-6	6.4	15.0	13.5	27.0					T-12091835	
	8	5/6"	RNB3-8	8.4								T-12091836	
4-6 (12-10)	3.5	#6	RNB5-3.7	3.7	7.2	6.1	15.7	6.0	5.6	3.4	1.0	T-12091837	
	4	#8	RNB5-4	4.3								T-12091838	
	4	#8	RNBL5-4		9.5	6.1	15.7					T-12091839	
	5	#10	RNB5-5	5.3								T-12091840	
	6	1/4 "	RNB5-6	6.4	12.0	10.5	22.5					T-12091841	
	6	1/4"	RNBMS-6			13.0	25.0					T-12091842	
	8	5/16 "	RNB5-8	8.4	15.0	13.3	27.0					T-12091843	
	10	3/8"	RNB5-10	10.5								T-12091844	

Product Description:

A **non-insulated terminal** is an electrical connector that is used to join or hold a wire together. These electrical connectors are generally made of metal, providing resistance to corrosion and electrical conduction without requiring insulation. Non-insulated terminals are ubiquitous; they're found in electrical and electronic equipment, automotive parts, home appliances, and many other applications. These terminals are usually made of a conductive material, like copper or aluminum, that offers good conductivity properties and reliable electrical connections. It is possible to find non-insulated terminals in a variety of shapes and sizes, including round, flat, U-shaped, and F-shaped sizes, which can meet varied connection needs.

Non-insulated terminals can be connected to wires in multiple ways. Bolting, crimping, and welding are three of the most common ways to join non-insulated terminals with a wire.

Technical Parameters:

Specification	Details
Product Name	Ring Cable Lugs
Material	Copper
Temperature Range	-40°C To +105°C
Application	Electrical Connections
Shape	Ring

Finish	Tin Plated
Brand	TLC
Package	Bag, Carton, Reel
Type	Non-Insulated Ring Terminal
Color	Silver

Applications:

Ring Cable Lugs from TLC are the perfect choice for secure electrical connections. Made from high quality tin-plated copper, these non-insulated ring terminals come with a temperature range of -40°C to +105°C and a silver color. With UL, CUL, and CE certifications, the Ring Cable Lugs provide reliable, safe, and easy connections. The minimum order quantity is 1000 and the price is USD for each item. Packaging details include bag and carton package, and delivery time is 5-30 working days. Payment terms are T/T and the supply ability is 1KK pcs per month.

Customization:

Custom-made Ring Cable Lugs

We provide custom-made ring cable lugs with Brand Name: TLC, Model Number: RNB. The product is UL, CUL, CE certified with minimum order quantity of 1000. The price is USD. It is packaged in bag and carton package with delivery time of 5-30 working days. Payment terms is T/T. We have the ability to provide 1KK pcs per month. It has a temperature range of -40°C To +105°C. The product is mainly used for electrical connections.

Our custom-made ring cable lugs are perfect for various cable connections. It is ideal for cable ring lug, Ring terminal lug, cable ring lug connector, cable ring lugs and other related applications.

Support and Services:

Ring Cable Lugs Technical Support and Service

Ring Cable Lugs provides a full range of technical support and services to help customers get the most out of their products. Our experienced team of experts is available to answer any questions and provide assistance with installation, troubleshooting, and maintenance.

We also offer a variety of resources including product manuals, tutorials, and FAQs to help you get the most out of your Ring Cable Lugs. In addition, we provide warranty services to ensure that you have a long-lasting product.

If you have any questions or need any assistance, please feel free to contact our team of experts for more information or help.

Packing and Shipping:

Ring Cable Lugs Packaging and Shipping

The Ring Cable Lugs are packaged in industrial grade cardboard boxes for maximum protection during transportation. The boxes are labeled with the product name and size for easy identification. The boxes are then sealed with industrial grade tape for extra protection and for tamper proofing.

The Ring Cable Lugs are shipped via freight delivery services for large orders, and by express mail for small orders. All shipments are tracked for security and customer convenience.

FAQ:

Q: What is Ring Cable Lugs?

A: Ring Cable Lugs is a kind of electrical connection fittings, produced by TLC, with the model number RNB.

Q: Where does Ring Cable Lugs come from?

A: Ring Cable Lugs is made in China.

Q: Does Ring Cable Lugs have any certifications?

A: Yes, Ring Cable Lugs has UL, CUL and CE certifications.

Q: What is the minimum order quantity for Ring Cable Lugs?

A: The minimum order quantity for Ring Cable Lugs is 1000 pieces.

Q: What is the price of Ring Cable Lugs and what is the delivery time?

A: The price of Ring Cable Lugs is USD and the delivery time is 5-30 working days. Payment terms is T/T and we can supply 1KK pcs per month. The package of Ring Cable Lugs is bag, carton package.



TLC TERMINALS TECHNOLOGY LIMITED



+8615338876153



joe@t-terminals.com



cableslugs.com

4B Huafeng Industrial Park Baolong 1 Road Baolong Street, Longgang District, Shenzhen City

