

10-16mm² Closed Non Insulated Ring Terminals For Wire Connection With Brazed Seam OT Round

Our Product Introduction

Basic Information

- Place of Origin: CHINA
- Brand Name: TLC
- Certification: UL, CUL, CE
- Model Number: OT
- Minimum Order Quantity: 1000
- Price: USD
- Packaging Details: Carton
- Delivery Time: 5-30 working days
- Payment Terms: T/T
- Supply Ability: 1KK pcs per month



Product Specification

- Temperature Rating: 105°C
- Material: Copper
- Insulation: Non-Insulated
- Product Name: Non Insulated Ring Terminals
- RoHS Compliant: Yes
- Barrel Type: Closed
- Color: Silver
- Tin Plated: Yes
- Highlight: ring terminal non insulated 16mm², 10mm² Closed ring terminal non insulated, 10mm² lugs ring type For Wire Connection





Non-Insulated with Brazed Seam

OT ROUND TERMINALS

Material
Terminal Body: Copper
Plating: Tin

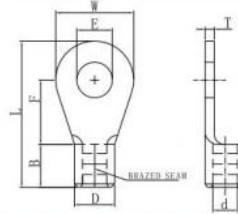

WIRE RANGE	STUD SIZE		ITEM NO	DIMENSION mm								P/N	QTY BOX
	mm2 (A.W.G)	Metric		E	W	d	D	B	F	L	T		
10 (8)	4	#8	OT8-4	4.3					8.5	21.0		T-12093143	1000
	5	#10	OT8-5	5.5	12.0	4.5	7	8.0	9.5	21.0	1.2	T-12093144	
	6	1/4"	OT8-6	6.5					11.5	21.0		T-12093145	
10 (8)	4	#8	OT10-4	4.3	12.0				8.5	23.0		T-12093146	1000
	5	#10	OT10-5	5.5					9.5	25.0		T-12093147	
	6	1/4"	OT10-6	6.5					11.5	27.0		T-12093148	
	8	5/16"	OT10-8	8.5	16.0	5.2	7.6	8.5	13.5	30.0	1.2	T-12093149	
	10	3/8"	OT10-10	10.5	18.0				16.5	34.0		T-12093150	
	12	1/2"	OT10-12	13.0	23.0				19.0	39.5		T-12093151	
16 (6)	4	#8	OT14-4	4.3	12.0				9.5	25.5		T-12093152	500
	5	#10	OT14-5	5.5	12.0					25.5		T-12093153	
	6	1/4"	OT14-6	6.5	12.0				11.5	25.5		T-12093154	
	6	1/4"	OT14-6L	6.5	15.0	6.1	8.7	11.0	13.5	31.0	1.5	T-12093155	
	8	5/16"	OT14-8	8.5	15.0				12.5	31.0		T-12093156	
	10	3/8"	OT14-10	10.5	15.0				16.5	31.0		T-12093157	
16 (6)	5	#10	OT16-5	5.5	14.0				9.5	27.0		T-12093158	500
	6	1/4"	OT16-6	6.5	18.0				11.5	31.0		T-12093159	
	8	5/16"	OT16-8	8.5	18.0	6.9	9.9	10.5	12.5	33.0	1.5	T-12093160	
	10	3/8"	OT16-10	10.5	20.0				16.5	37.0		T-12093161	
	12	1/2"	OT16-12	13.0	23.0				19.5	41.5		T-12093162	

Product Description:

Non-insulated terminals are widely used in a wide range of industries, from electrical and electronic equipment, to automotive industry, to home appliances. These connectors are made of metal and used to connect or secure a wire. Unlike other kinds of terminals, these do not provide an insulating function.

Non-insulated terminals are essential in providing reliable and secure connections. Various applications exist for these connectors, including wires outdoors, which are able to regulate power to electrical motors, lights and security systems. Additionally, in commercial settings, these terminals are used for wires and cables in metal and plastic parts.

As the demand for technology continues to grow, the need for non-insulated terminals also grows. As with any technology, new trends are always emerging, meaning new products and materials are constantly being developed to fulfill the ever-changing needs of the industry.

Features:

Non-insulated terminals are typically constructed out of conductive materials, such as copper and aluminum. These materials have excellent conductive properties that support reliable electrical connections. Non-insulated terminals come in a wide range of shapes including round, flat, U-shaped and F-shaped so that various connection needs can be met. It is possible to affix non-insulated terminals to the wire using bolts, crimping, or welding.

Applications:

Non-insulated terminals are often used to fix wires in place in the electronics and automotive industries. With their specially designed construction, they provide a secure way to ensure wires don't move or come loose. For instance, U-shaped terminals are typically highlighted as a popular choice. They can be used to clip the wires in place and then kept further secured with the help of bolts or other fastenings.

Customization:

Non Insulated Ring Terminals

Brand Name: TLC

Model Number: RNB, DRNB, OT

Place of Origin: CHINA

Certification: UL, CUL, CE

Minimum Order Quantity: 1000

Price: USD

Packaging Details: Carton

Delivery Time: 5-30 working days

Payment Terms: T/T

Supply Ability: 1KK pcs per month

RoHS Compliant: Yes

Product Name: **Non Insulated Ring Terminals**

Barrel Type: Closed

Insulation: Non-Insulated

Temperature Rating: 105°C

TLC provides a wide range of **ring terminals lug, ring cable lug, ring terminals, ring connectors, non insulated ring terminals**. High quality, UL, CUL, CE certified, RoHS compliant, temperature rating 105°C, minimum order quantity 1000. Reasonable price and fast delivery.

Support and Services:

Non Insulated Ring Terminals provide technical support and services that include:

Installation assistance

Product reviews

Troubleshooting help

Replacement parts

User manuals

Technical advice

Packing and Shipping:

Packaging and Shipping for Non Insulated Ring Terminals

Non Insulated Ring Terminals are packaged in boxes that are designed to protect their contents during transit. The box is then sealed with a plastic wrap and marked with the product code. The boxes are then placed into a larger box for shipping.

The larger box is also sealed with a plastic wrap and marked with the product code and the shipping address. The box is then secured with tape and shipped to the destination.

FAQ:

Non Insulated Ring Terminals

Q: What is the Brand Name of Non Insulated Ring Terminals?

A: The Brand Name of Non Insulated Ring Terminals is TLC.

Q: What is the Model Number of Non Insulated Ring Terminals?

A: The Model Number of Non Insulated Ring Terminals is RNB, DRNB, OT.

Q: Where is the Place of Origin of Non Insulated Ring Terminals?

A: The Place of Origin of Non Insulated Ring Terminals is CHINA.

Q: What is the Certification of Non Insulated Ring Terminals?

A: The Certification of Non Insulated Ring Terminals is UL, CUL, CE.

Q: What is the Minimum Order Quantity of Non Insulated Ring Terminals?

A: The Minimum Order Quantity of Non Insulated Ring Terminals is 1000.

Q: What is the Price of Non Insulated Ring Terminals?

A: The Price of Non Insulated Ring Terminals is USD.

Q: What is the Packaging Details of Non Insulated Ring Terminals?

A: The Packaging Details of Non Insulated Ring Terminals is Carton.

Q: What is the Delivery Time of Non Insulated Ring Terminals?

A: The Delivery Time of Non Insulated Ring Terminals is 5-30 working days.

Q: What is the Payment Terms of Non Insulated Ring Terminals?

A: The Payment Terms of Non Insulated Ring Terminals is T/T.

Q: What is the Supply Ability of Non Insulated Ring Terminals?

A: The Supply Ability of Non Insulated Ring Terminals is 1KK pcs per month.



TLC TERMINALS TECHNOLOGY LIMITED



+8615338876153



joe@t-terminals.com



cableslugs.com

4B Huafeng Industrial Park Baolong 1 Road Baolong Street, Longgang District, Shenzhen City