

## Big Copper Tubular Lug Terminals Customized Non-Insulated Copper Wire Terminals Cable Connectors

Our Product Introduction

for more products please visit us on [cableslugs.com](http://cableslugs.com)

### Basic Information

- Place of Origin: China
- Brand Name: TLC
- Certification: UL, cUL, CE
- Model Number: DT series
- Minimum Order Quantity: 10-1000pcs
- Price: 0.01~5USD/PC
- Packaging Details: Carton size: 33X25X21CM
- Delivery Time: 5-20 working days
- Supply Ability: 600-800K pcs per month



### Product Specification

- Material: T2 Purple Copper
- Special: OEM Service Offered
- Packing Detail: 100pcs A Bag
- Country Of Origin: ShenZhen City ,China
- Color: Silver
- Type: DT Series Lugs Terminals
- Cable Size: 6mm<sup>2</sup>-625mm<sup>2</sup>
- Application: Industrial, Commercial, And Residential Use
- Port: ShenZhen Port
- Shape: Tubular
- Manufacturer: Various Manufacturers Available
- Insulation: Non-insulated
- Surface Treatment: Tinned
- Size: Various Sizes Available
- With Inspection Hole: No



### More Images



### Product Description

TLC was founded in 2011, is a high-tech enterprise focusing on the research & development, production, sales and service of copper terminals, with more than 210 employees. Providing one-stop services from product design, mold manufacturing, precision stamping, assembling, shipment to after-sales services. The factory has passed ISO9001, IATF16949 and other system certification; They are two manufacturing centers in Shenzhen and Wenzhou, annual production abilities are hundreds of millions of terminals.

**DT lugs Terminals Specification:**

Our Product

## DT LUGS TERMINALS

Material  
Terminal Body: Copper  
Plating: Tin

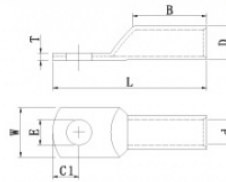

WIRE RANGE	STUD SIZE		ITEM NO	DIMENSION mm(inch)								P/N	QTY BOX
	mm2 (A.W.G)	Metric	Amerian	E	D	d	W	B	L	C1	T		
70 (2/0)	6.0	1/4	DT70 - 6	6.4	16.0	12.0	23.0	42.0	76.0	12.0	3.8	T-12098120	50
	8.0	5/16	DT70 - 8	8.4								T-12098121	
	10.0	3/8	DT70 - 10	10.5								T-12098122	
	12.0	1/2	DT70 - 12	13.0								T-12098123	
95 (3/0)	8.0	5/16	DT95 - 8	8.4	18.0	14.0	26.0	44.0	84.0	14.2	3.8	T-12098124	50
	10.0	3/8	DT95 - 10	10.5								T-12098125	
	12.0	1/2	DT95 - 12	13.0								T-12098126	
	14.0	9/16	DT95 - 14	15.0								T-12098127	
120 (4/0)	10.0	3/8	DT120 - 10	10.5	21.0	16.0	30.0	46.0	90.0	15.0	4.8	T-12098128	30
	12.0	1/2	DT120 - 12	13.0								T-12098129	
	14.0	9/16	DT120 - 14	15.0								T-12098130	
	16.0	5/8	DT120 - 16	17.0								T-12098131	

### Product Description:

#### High-quality DT lugs Terminals: The TLC Guarantee

Copper DT lugs Terminals, often referred to as cord end ferrules, play an important role in making secure and reliable electrical connections. At TLC, we take pride in offering a wide range of cable terminals that are designed to meet the most demanding industry specifications.

Our expert team is committed to manufacturing premium-grade cable terminals that offer exceptional resistance to corrosion, temperature variations and other environmental stress. Our products have had an outstanding record of performance in a variety of industries, ranging from industrial machinery and home applications to automotive and defense components.

Whether it's a simple cord end ferrule or a special design, TLC guarantees the highest quality of product that is customized to meet your specific needs. We make sure your cord end terminals provide the reliable and safe connection your system requires.

#### DT lugs Terminals Features:

Our DT lugs Terminals are designed to provide superior performance and long-term reliability. Their durable construction and excellent electrical conductivity make them ideal for even the most demanding applications.

We offer a wide range of sizes and configurations, so you're sure to find the perfect DT lugs Terminals for your specific wire gauge and terminal block.

#### Technical Parameters:

Copper DT lugs Terminals are designed for easy and quick installation, helping users to save time and effort in the wiring process. Moreover, they also offer a secure and vibration-resistant connection, which could effectively prevent the risk of loose or damaged wires.

Moreover, their using of these terminals could save the cost of labor since the wires do not need much manual processing. The DT lugs Terminals are more user-friendly and could greatly reduce tedious manual work.

<b>Applications:</b>
At our professional manufacturing company, TLC, we take pride in offering a wide range of high-quality DT lugs Terminals to cater to the diverse needs of our customers. We manufacture these terminals using premium-grade materials and engineer them to meet stringent industry standards.
Our DT lugs Terminals are highly durable and offer excellent electrical conductivity - even in demanding applications. They are available in various sizes and configurations, to accommodate different wire gauges and terminal blocks.
<b>Customization:</b>
Customized DT lugs Terminals from TLC
Brand Name: TLC
Model Number: DT Series
Place of Origin: China
Certification: UL, cUL, CE
Minimum Order Quantity: 100pcs
Price: USD
Packaging Details: Bag and Carton package
Delivery Time: 5-20 working days
Payment Terms: T/T
Supply Ability: 600K - 800K pcs per month
Package Content: 1000-50pcs
Connector Type: Lugs Terminals
Wire Range: 6(12-10)- 625(250/300) mm <sup>2</sup> (A.W.G)
Shape: Pin
Coating: Tin

#### Agency Approvals:

##### IATF16949



##### ISO9001-2015



#### Technical Support and Services:

##### DT lugs Terminals Technical Support and Service

We provide comprehensive technical support and service for our DT lugs Terminals products. Our team of experienced professionals is available to answer any questions you may have about installation, operation, and maintenance. We offer a dedicated customer service hotline to provide quick and efficient assistance. We also provide a range of online resources and documentation to help you get the most out of DT lugs Terminals product. Our team is always available to provide technical advice and support.

We understand the importance of keeping your DT lugs Terminals product up-to-date with the latest software and hardware updates. We provide regular software updates and notifications to ensure your product is always running optimally. We strive to provide the best customer experience and satisfaction. If you have any questions or concerns, please don't hesitate to contact us.

#### TLC factory's pictures:

**Wire cutting machine department**



**Stamping machines**



**Automatic department**



**Heat treatment**





**Laboratory**



#### **Professional Packing and Shipping:**

Packaging and Shipping of DT lugs Terminals.

DT lugs Terminals are usually shipped in bulk, in protective packaging such as cardboard boxes and plastic bags. Depending on the product, it may also be necessary to use cushioning materials like bubble wrap or foam to ensure that the product arrives in its original condition. In addition, it is important to ensure that the product is properly labelled with all relevant information, such as product name, weight, dimensions, and manufacturer's details. This will help to ensure that the product is properly identified when it arrives at its destination.

When shipping DT lugs Terminals, it is important to take into account the size and weight of the product, as well as the distance it needs to travel. If necessary, it may be necessary to use a specialist shipping company to ensure that the product arrives safely and on time. It is also important to factor in any possible delays due to customs clearance or other unforeseen circumstances. It is advisable to use a tracked service to ensure that the product can be tracked at all times.

#### **Packaging carton:**



#### **FAQ:**

##### **Frequently Asked Questions:**

Q: What is the brand name of the DT lugs Terminals?

A: The brand name of the DT lugs Terminals is TLC.

Q: What is the model number of the DT lugs Terminals?

A: The model number of the DT lugs Terminals is DT series.

Q: Where is the place of origin of theDT lugs Terminals?

A: The place of origin of theDT lugs Terminals is China.

Q: What certifications does the DT lugs Terminals have?

A: The Pin Terminals have UL, cUL, and CE certifications.

Q: What is the minimum order quantity of theDT lugs Terminals?

A: The minimum order quantity of theCopper DT lugs Terminals is 50-1000pcs.



**TLC TERMINALS TECHNOLOGY LIMITED**



+8615338876153



joe@t-terminals.com



cableslugs.com

4B Huafeng Industrial Park Baolong 1 Road Baolong Street, Longgang District, Shenzhen City