

High Temperature Rated Mechanical Cable Lugs 0.5-30mm² Cable Terminal Lugs

Our Product Introduction

Basic Information

- Place of Origin: China
- Brand Name: TLC
- Certification: UL, CUL, CE
- Model Number: SC
- Minimum Order Quantity: 1000
- Price: USD
- Packaging Details: Carton package
- Delivery Time: 5-30 days
- Payment Terms: T/T
- Supply Ability: 1KK pcs per month



Product Specification

- Temperature Rating: High
- Color: Silver
- Current Rating: High
- Product Name: Mechanical Cable Lugs
- Packaging: Bag, Box, Carton
- Surface Treatment: Tin Plated
- Application: Electrical Connections
- MOQ: 1000 Pieces
- Highlight: **High Temperature Rated Mechanical Cable Lugs , 0.5mm² Cable Terminal Lugs, 30mm² Cable Terminal Lugs**

for more products please visit us on cableslugs.com



Non- Insulated - Copper Lugs

SC LUGS TERMINALS

Material
Terminal Body: Copper
Plating: Tin

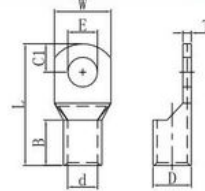

WIRE RANGE	STUD SIZE		ITEM NO	DIMENSION mm								P/N	QTY BOX
	mm2 (A.W.G)	Metric		E	D	d	W	B	C1	L	T		
0.5-1.5 (22-16)	4	#8	SC1.5 - 4	4.3	4.0	2.0	8.0	5.0	4.5	16.5	1.00	T-12131101	1000
	5	#10	SC1.5 - 5	5.3			8.0		4.5	16.5	1.00	T-12131102	
	6	1/4	SC1.5 - 6	6.4			8.0		4.5	16.5	1.00	T-12131103	
1.5-2.5 (16-14)	4	#8	SC2.5 - 4	4.3	4.5	2.9	8.0	7.0	4.5	19.0	1.10	T-12131104	
	5	#10	SC2.5 - 5	5.3			8.0		5.0	21.0	1.05	T-12131105	
	6	1/4	SC2.5 - 6	6.4			10.0		5.0	21.0	1.00	T-12131106	
	8	5/16	SC2.5 - 8	8.4			13.0		6.5	24.0	0.88	T-12131107	
2.5-4 (14-12)	4	#8	SC4 - 4	4.3	5.2	3.6	10.0	7.0	5.0	21.0	1.00	T-12131108	
	5	#10	SC4 - 5	5.2			10.0		5.0	21.0	1.00	T-12131109	
	6	1/4	SC4 - 6	6.5			10.0		5.0	21.0	1.00	T-12131110	
	8	5/16	SC4 - 8	8.4			13.0		6.0	24.0	0.80	T-12131111	
4-6 (12-10)	4	#8	SC6-4	4.3	5.5	3.8	10.5	10.0	5.5	24.0	1.15	T-12131112	
	5	#10	SC6 - 5	5.3			10.5		5.5	24.0	1.15	T-12131113	
	6	1/4	SC6 - 6	6.4			11.0		5.5	24.5	1.10	T-12131114	
	8	5/16	SC6 - 8	8.4			12.0		6.5	26.5	1.00	T-12131115	
10 (8)	4	#8	SC10-4	4.3	6.5	4.9	12.0	10.0	5.5	25.0	1.20	T-12131116	
	5	#10	SC10 - 5	5.3			12.0		5.5	25.0	1.20	T-12131117	
	6	1/4	SC10 - 6	6.4			12.0		5.5	25.0	1.20	T-12131118	
	8	5/16	SC10 - 8	8.4			12.5		6.5	27.0	1.15	T-12131119	
	10	3/8	SC10- 10	10.5	7.0	5.0	18.0		10.0	34.5	0.93	T-12131120	
	12	1/2	SC10 - 12	13.0			18.5		13.0	39.5	0.90	T-12131121	

SC LUGS TERMINALS

Material
Terminal Body: Copper
Plating: Tin

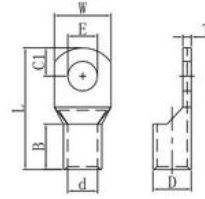

WIRE RANGE	STUD SIZE		ITEM NO	DIMENSION mm								P/N	QTY BOX
	mm2 (A.W.G)	Metric		Amerian	E	D	d	W	B	C1	L		
16 (6)	4	#8	SC16 - 4	4.3	7.5	5.8	12.2	11.4	6.5	30.0	1.6	T-12131122	500
	5	#10	SC16 - 5	5.4								T-12131123	
	6	1/4	SC16 - 6	6.4								T-12131124	
	8	5/16	SC16 - 8	8.4								T-12131125	
	10	3/8	SC16 - 10	10.5			14.0	7.0	1.26	T-12131126			
25 (4)	5	#10	SC25-5(13)	5.3	7.2	9.0	13.0	12.0	8.0	32.0	1.7	T-12131127	200
	6	1/4	SC25 - 6(13)	6.4								T-12131128	
	8	5/16	SC25 - 8(13)	8.4								T-12131129	
	4	#8	SC25-4	4.2	9.5	7.5	13.8	7.8	35.0	1.9	T-12131130		
	5	#10	SC25-5	5.3							T-12131131		
	6	1/4	SC25 - 6	6.4							T-12131132		
	8	5/16	SC25 - 8	8.4							T-12131133		
	10	3/8	SC25 - 10	10.5			15.0	9.0	1.8	T-12131134			
	12	1/2	SC25 - 12	13.0			20.5	13.0	45.0	1.18	T-12131135		
	35 (2)	6	1/4	SC35 - 6			6.4	10.8	8.5	15.7	14.0	8.0	
8		5/16	SC35 - 8	8.4	T-12131137								
10		3/8	SC35 - 10	10.5	T-12131138								
12		1/2	SC35 - 12	13.0	10.5	8.3	18.7	15.5	9.0	38.0	1.7	T-12131139	
6		1/4	SC35 - 6-GTNR	6.4	11.3	8.7	16.5	15.0	9.0	38.0	2.6	T-12131140	
8		5/16	SC35 - 8-GTNR	8.4								T-12131141	
10		3/8	SC35 - 10-GNTR	10.5								39.0	T-12131142

TLC TERMINALS INC.
Terminals

Product Description:

Cable lugs are an important element in any electrical system, as they provide secure and reliable connections between wires or cables and electrical devices and equipment. When properly installed, cable lugs ensure a strong and stable electrical connection that is crucial for efficient transmission of electrical power or signals between devices. Without a properly installed cable and terminal lugs, connections may become loose, which can result in poor performance, overheating, or even electrical failures.

Applications:

TLC SC Mechanical Cable Lugs are made of high-quality materials and are designed for high temperature and current ratings. The lugs are tin plated for better corrosion resistance and feature a variety of packaging options, including bags, boxes, and cartons. These lugs can be used in a variety of electrical connections, such as tube lugs, cable lugs, and other tube and cable lug connectors. The lugs provide a reliable and secure connection that is resistant to wear and tear and provides a high level of performance and safety. TLC SC Mechanical Cable Lugs are the perfect solution for any electrical connection needs.

Customization:

Customized Service for Mechanical Cable Lugs

Brand Name: **TLC**

Model Number: **SC**

Place of Origin: **China**

MOQ: **1000 Pieces**

Product Name: **Mechanical Cable Lugs**

Current Rating: **High**

Application: **Electrical Connections**
Material: **Copper**
Main Features: **Tube Lug, Cable Lug, Terminal Lug**

Support and Services:

Mechanical Cable Lugs provides technical support and services for customers around the world. We provide technical documentation, data sheets, tutorials, FAQs, and more to help customers get the most out of their products. We also offer live online and telephone support to help troubleshoot any issues that may arise. For any additional questions or concerns, please contact us directly and we will be happy to assist you.

Packing and Shipping:

Packaging and Shipping of Mechanical Cable Lugs

Mechanical cable lugs are packaged in boxes for shipping. Each box contains sufficient lugs to complete a typical job. The boxes are labeled to show the type of lug, the quantity, and the customer order number. Each box is then wrapped in a protective plastic bag. The boxes are placed on a pallet and secured with stretch wrap. The pallet is then shipped to the customer's location using a third-party shipping service. The customer will be notified of the shipment and will receive tracking information.

FAQ:

Q1: What is a Mechanical Cable Lugs?

A: Mechanical Cable Lugs are a type of connector which are used to terminate different types of electrical cables.

Q2: What is the Brand Name of the product?

A: The brand name of the product is TLC.

Q3: What is the Model Number of the product?

A: The model number of the product is SC.

Q4: Where is the product originated from?

A: This product is originated from China.

Q5: What are the application of Mechanical Cable Lugs?

A: Mechanical Cable Lugs are mainly used for connecting and terminating electrical cables in power distribution systems.



TLC TERMINALS TECHNOLOGY LIMITED



+8615338876153



joe@t-terminals.com



cableslugs.com

4B Huafeng Industrial Park Baolong 1 Road Baolong Street, Longgang District, Shenzhen City