

Tin Plated Electrical Connections Mechanical Cable Lugs 50-300mm² Cable Lug Copper

Our Product Introduction

for more products please visit us on cableslugs.com

Basic Information

- Place of Origin: China
- Brand Name: TLC
- Model Number: SC
- Minimum Order Quantity: 1000pcs
- Price: USD
- Packaging Details: Carton package
- Delivery Time: 5-30 days
- Payment Terms: T/T
- Supply Ability: 1KK pcs per month



Product Specification

- Product Name: Mechanical Cable Lugs
- Surface Treatment: Tin Plated
- Application: Electrical Connections
- Material: Copper
- Temperature Rating: High
- Current Rating: High
- Color: Silver
- Type: Crimped
- Highlight: **Electrical Connections Mechanical Cable Lugs SC**
, tlc 50mm² Cable Lug Copper Tin Plated,
300mm² Cable Lug Copper



Non-Insulated - Copper Lugs

SC LUGS TERMINALS

Material
Terminal Body: Copper
Plating: Tin

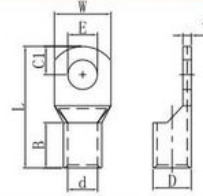

WIRE RANGE	STUD SIZE		ITEM NO	DIMENSION mm								P/N	QTY BOX
	mm2 (A.W.G)	Metric	Amerian	E	D	d	W	B	C1	L	T		
50 (1/0)	5	#10	SC50-5	5.3	12.6	9.9	18.0	16.0	10.0	45.0	2.5	T-12131143	100
	6	1/4	SC50-6	6.4								T-12131144	
	8	5/16	SC50-8	8.4								T-12131145	
	10	3/8	SC50-10	10.5								T-12131146	
	12	1/2	SC50-12	13.0								T-12131147	
50 (1/0)	6	1/4	SC50-6-GTNR	6.4	13.5	10.5	20.0	16.5	10.00	44.0	3.0	T-12131148	100
	8	5/16	SC50-8-GTNR	8.4								T-12131149	
	10	3/8	SC50-10-GTNR	10.5								T-12131150	
	12	1/2	SC50-12-GTNR	13.0								T-12131151	
50 (1/0)	6	1/4	SC50-6-1291	6.4	14.0	10.2	18.0	20.0	7.75	45.0	4.0	T-12131152	100
	8	5/16	SC50-8-1291	8.4								T-12131153	
	10	3/8	SC50-10-1291	10.5								T-12131154	
70 (2/0)	5	#10	SC70-5-21.5	5.3	15.0	12.0	21.5	19.0	12.0	50.5	3.0	T-12131155	50
	6	1/4	SC70-6-21.5	6.4								T-12131156	
	8	5/16	SC70-8-21.5	8.4								T-12131157	
	10	3/8	SC70-10-21.5	10.5								T-12131158	
	12	1/2	SC70-12-21.5	13.0								T-12131159	
70 (2/0)	5	#10	SC70-5	5.3	15.0	12.0	21.8	19.0	12.0	50.5	3.0	T-12131163	50
	6	1/4	SC70-6	6.4								T-12131164	
	8	5/16	SC70-8	8.4								T-12131165	
	10	3/8	SC70-10	10.5								T-12131166	
	12	1/2	SC70-12	13.0								T-12131167	

SC LUGS TERMINALS

Material
Terminal Body: Copper
Plating: Tin

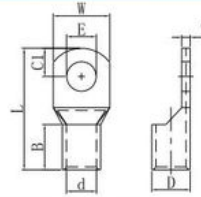

WIRE RANGE	STUD SIZE		ITEM NO	DIMENSION mm								P/N	QTY BOX
	mm2 (A.W.G)	Metric		E	D	d	W	B	C1	L	T		
95 (3/0)	6	1/4	SC95-6	6.4	17.4	13.5	25.5	23.0	12.5	58.0	3.8	T-12131168	30
	8	5/16	SC95 - 8	8.4								T-12131169	
	10	3/8	SC95 - 10	10.5								T-12131170	
	12	1/2	SC95 - 12	13.0								T-12131171	
	14	9/16	SC95 - 14	15.0								T-12131172	
95 (3/0)	6	1/4	SC95-6-GTNR	6.4	18.0	14.0	26.0	20.0	13.0	55.0	4.0	T-12131173	30
	8	5/16	SC95 - 8-GTNR	8.4								T-12131174	
	10	3/8	SC95 - 10-GTNR	10.5								T-12131175	
	12	1/2	SC95 - 12-GTNR	13.0								T-12131176	
120 (4/0)	6	1/4	SC120-6	6.4	19.5	15.0	28.0	22.0	15.0	63.0	4.4	T-12131177	30
	8	5/16	SC120-8	8.4								T-12131178	
	10	3/8	SC120 - 10	10.5								T-12131179	
	12	1/2	SC120 - 12	13.0								T-12131180	
	14	9/16	SC120 - 14	15.0								T-12131181	
	16	5/8	SC120 - 16	17.0								T-12131182	
150 (4/0)	6	1/4	SC150-6	6.4	23.0	18.0	32.5	26.0	15.5	68.5	5.0	T-12131187	30
	8	5/16	SC150-8	8.4								T-12131188	
	10	3/8	SC150 - 10	10.5								T-12131189	
	12	1/2	SC150 - 12	13.0								T-12131190	
	14	9/16	SC150 - 14	15.0								T-12131191	
	16	5/8	SC150 - 16	15.0								T-12131192	

SC LUGS TERMINALS

Material
Terminal Body: Copper
Plating: Tin

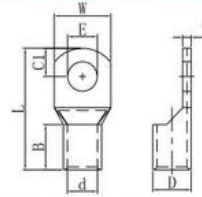

WIRE RANGE	STUD SIZE		ITEM NO	DIMENSION mm								P/N	QTY BOX
	mm2 (A.W.G)	Metric		E	D	d	W	B	C1	L	T		
185 (300/350)	10	3/8	SC185 - 10	10.5	24.3	19.3	34.8	33.5	18.0	82.6	5.0	T-12131193	10
	12	1/2	SC185 - 12	13.0								T-12131194	
	14	9/16	SC185 - 14	15.0								T-12131195	
	16	5/8	SC185 - 16	15.0								T-12131196	
240 (400/450)	10	3/8	SC240 - 10	10.5	27.0	21.0	38.2	37.8	18.8	90.0	6.0	T-12131197	5
	12	1/2	SC240 - 12	13.0								T-12131198	
	14	9/16	SC240 - 14	16.0								T-12131199	
	16	5/8	SC240 - 16	17.0								T-12131200	
	20	3/4	SC240 - 20	21.0								T-12131201	
300 (500)	10	3/8	SC300 - 10	10.5	30.0	23.5	43.5	42.5	19.8	97.5	6.5	T-12131202	5
	12	1/2	SC300 - 12	13.0								T-12131203	
	14	9/16	SC300 - 14	16.0								T-12131204	
	16	5/8	SC300 - 16	17.0								T-12131205	
	20	3/4	SC300 - 20	21.0								T-12131206	

Product Description:

The combination of lugs and cable is essential to ensure a reliable and sturdy electrical connection. This is crucially important for the smooth transmission of electrical power or signals between machines. If the cable and cable lugs are not properly fixed, it may cause problems such as poor performance, abnormal temperate and even electrical failures.

Cable lugs are paramount elements in the electrical systems and play an active role in providing safe and consistent connections between wires or cables and the electrical equipments or devices. To get maximum electrical performance and maintain safety, it is vital to make sure that the cable lugs have been correctly installed.

Applications:

TLC Mechanical Cable Lugs are designed for joining two or more strands of cable end. They are available in a variety of sizes and can be used in a number of applications. These lugs are suitable for use with a wide range of cable types from standard single core cables to multi-core armoured cables. With their high temperature rating and tin plated surface treatment, they are perfect for use in the most demanding applications.

The lugs can be used in both indoor and outdoor applications and are ideal for use in automotive wiring, electrical control panels, electrical equipment and other electrical installations. They are also suitable for use in electrical appliances such as washing machines, dishwashers, and other appliances.

TLC Mechanical Cable Lugs are designed for easy installation and are supplied with the necessary tools and accessories. The crimping tool ensures that the lug is securely attached to the cable and that the connection is secure. The insulated lugs provide additional protection against short circuits. The lugs are available in a variety of colors such as silver, gold and black.

The minimum order quantity for TLC Mechanical Cable Lugs is 1000 pieces and the product is supplied in bags, boxes and cartons. The lugs are suitable for use in a variety of applications and are available in a range of sizes from 10mm to 70mm. They can be used for standard single core cables, multi-core armoured cables, terminal lugs, tube lugs, and other types of cable connections.

Customization:

Customized Mechanical Cable Lugs -----
Brand Name: TLC
Model Number: SC
Place of Origin: China
Material: Copper
Product Name: Mechanical Cable Lugs
Packaging: Bag, Box, Carton
Surface Treatment: Tin Plated
MOQ: 1000 Pieces
Keywords: terminal lug, cable lug, tube lug

Support and Services:

Mechanical Cable Lugs Technical Support and Service
At XYZ Company, we understand the importance of reliable electrical connections and provide professional technical support and services for our mechanical cable lugs. Our team of experienced professionals provide knowledgeable technical advice, quality assurance and performance assurance for our customers.
We provide a range of services for mechanical cable lugs, including design assistance, installation, testing, troubleshooting, and maintenance. Our team is committed to providing the highest quality service and is available to answer any questions you may have. In addition, we offer a variety of warranty options for our mechanical cable lugs, so you can be sure that your investment is protected.
At XYZ Company, we take pride in providing our customers with the highest quality Mechanical Cable Lugs products and technical support. Our team is committed to providing timely and effective assistance, so you can trust that your electrical connections will remain reliable and safe. Contact us today for more information about our Mechanical Cable Lugs technical support and services.

Packing and Shipping:

Mechanical Cable Lugs are packaged and shipped in a manner that ensures their safety and integrity during transportation. The ----- packaging is designed to protect the product from dust, moisture, and other environmental conditions. All Mechanical Cable Lugs are packed in individual boxes, with the product protected from any external damage. The boxes are then placed in sturdy cardboard boxes, lined with bubble wrap for additional protection. The boxes are sealed with strong adhesive tape to ensure that the contents remain intact during shipment. The packaging and shipping process is designed to ensure that the product arrives promptly and safely at its destination.

FAQ:

A: The brand name of the Mechanical Cable Lugs is TLC. Q: What is the model number of the Mechanical Cable Lugs?
A: The model number of the Mechanical Cable Lugs is SC. Q: Where is the Mechanical Cable Lugs manufactured?
A: The Mechanical Cable Lugs is manufactured in China. Q: What are the features of the Mechanical Cable Lugs?
A: The Mechanical Cable Lugs are designed for easy installation and durable performance with corrosion resistance. Q: How to install the Mechanical Cable Lugs?
A: The Mechanical Cable Lugs can be easily installed with a hexagonal wrench.



TLC TERMINALS TECHNOLOGY LIMITED



+8615338876153



joe@t-terminals.com



cableslugs.com

4B Huafeng Industrial Park Baolong 1 Road Baolong Street, Longgang District, Shenzhen City