

70-150mm² Mechanical Cable Lugs 1000 Pieces Copper Electrical Connections Non-Insulated

Our Product Introduction

Basic Information

- Place of Origin: China
- Brand Name: TLC
- Certification: UL, CUL, CE
- Model Number: DT, HUP
- Minimum Order Quantity: 1000
- Price: USD
- Packaging Details: PE bag, Carton
- Delivery Time: 5-30 working days
- Payment Terms: T/T
- Supply Ability: 300-800K pcs per month



Product Specification

- Current Rating: High
- Application: Electrical Connections
- Color: Silver
- Packaging: Bag, Box, Carton
- MOQ: 1000 Pieces
- Type: Crimped
- Surface Treatment: Tin Plated
- Product Name: Cable Lugs
- Highlight: **150mm² Mechanical Cable Lugs,
70mm² Mechanical Cable Lugs,
copper wire terminals 150mm²**



for more products please visit us on cableslugs.com



Non- Insulated - Copper Lugs

DT LUGS TERMINALS

Material
Terminal Body: Copper
Plating: Tin

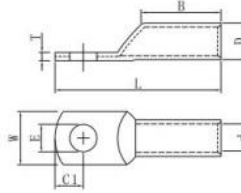

WIRE RANGE	STUD SIZE		ITEM NO	DIMENSION mm(inch)								P/N	QTY BOX
	mm2 (A.W.G)	Metric		E	D	d	W	B	L	C1	T		
70 (2/0)	6.0	1/4	DT70 - 6	6.4	16.0	12.0	23.0	42.0	76.0	12.0	3.8	T-12098120	50
	8.0	5/16	DT70 - 8	8.4								T-12098121	
	10.0	3/8	DT70 - 10	10.5								T-12098122	
	12.0	1/2	DT70 - 12	13.0								T-12098123	
95 (3/0)	8.0	5/16	DT95 - 8	8.4	18.0	14.0	26.0	44.0	84.0	14.2	3.8	T-12098124	50
	10.0	3/8	DT95 - 10	10.5								T-12098125	
	12.0	1/2	DT95 - 12	13.0								T-12098126	
	14.0	9/16	DT95 - 14	15.0								T-12098127	
120 (4/0)	10.0	3/8	DT120 - 10	10.5	21.0	16.0	30.0	46.0	90.0	15.0	4.8	T-12098128	30
	12.0	1/2	DT120 - 12	13.0								T-12098129	
	14.0	9/16	DT120 - 14	15.0								T-12098130	
	16.0	5/8	DT120 - 16	17.0								T-12098131	
150 (250/300)	12	1/2	DT150 - 12	13.0	23.0	17.0	33.0	50.0	98.0	16.0	5.7	T-12098132	30
	14	9/16	DT150 - 14	15.0								T-12098133	
	16	5/8	DT150 - 16	17.0								T-12098134	
	18	11/16	DT150 - 18	19.0								T-12098135	

120 TLC TERMINALS INC.
Terminals

Product Description:

Lugs terminals are indispensable components for electrical systems. They play a vital role in creating a secure and reliable connection between wires or cables and electrical devices or equipment.

The quality and accuracy of an installation of these terminals are paramount. These can have a significant influence on the performance and safety of the electrical systems. Thus, it is of utmost importance that lugs terminals are installed in the right manner.

Features:

The **combination of lugs and terminals** is essential for any electrical system, guaranteeing a secure and stable connection in order to ensure effective electrical power and signal transfer between devices. If the lugs and terminals are properly installed, it helps avoid the issues arising from a loose connection, such as performance problems, overheating or even electrical failures.

Applications:

Lugs terminals are an indispensable part in electrical systems. They play an indispensable role in linking more kinds of wires and cables with different electric tools and devices.

Lugs are small metal pieces, which can be either crimped or soldered with wires. Their purpose is to make a strong and reliable link with terminals. Meanwhile, lugs come into distinct sizes and shapes, thus they can fit different wire gauges and terminal types.

Support and Services:

Technical Support and Service for Mechanical Cable Lugs

We offer technical support and services for our mechanical cable lugs to ensure safe and reliable operations. Our experts are available to answer any questions or concerns you may have about the product.

Installation

We offer installation services for our mechanical cable lugs to ensure the safe and reliable connection of wires to the equipment. Our experienced technicians will make sure that the lugs are properly installed and function correctly.

Inspection and Maintenance

We offer inspection and maintenance services for our mechanical cable lugs to ensure the safe and reliable connection of wires to the equipment. Our experienced technicians will inspect the lugs for any signs of wear or damage and will repair or replace any damaged parts. We also provide regular maintenance to keep the lugs functioning properly.

Testing

We offer testing services for our mechanical cable lugs to ensure the safe and reliable connection of wires to the equipment. Our experienced technicians will test the lugs for any signs of wear or damage and will repair or replace any damaged parts. We also provide regular testing to keep the lugs functioning properly.

Packing and Shipping:

Packaging and Shipping for Mechanical Cable Lugs

Mechanical cable lugs are shipped in protective packaging, such as bubble wrap, air pillows, and cardboard boxes. The lugs should also be secured with foam cushioning or bubble wrap to prevent them from moving around during shipping. The lugs should be placed in a box that is large enough to accommodate the lugs and any accessories that they may come with. The box should also be labeled clearly with the product name, description, and other relevant information.

The shipping method should depend on the size and weight of the lugs. If the lugs are small and lightweight, then they can be shipped through a regular postal service. If the lugs are larger and heavier, then they should be shipped through a courier service. The shipping cost should also be taken into consideration when selecting a shipping method.

It is important to ensure that the lugs are properly packaged and shipped to prevent any damage during shipping. Mechanical cable lugs are an important part of any electrical system and it is important to ensure that they are properly handled and shipped to prevent any issues.

FAQ:

Q&A for Mechanical Cable Lugs

Q1: What is the Brand Name of Mechanical Cable Lugs?

A1: The Brand Name of Mechanical Cable Lugs is TLC.

Q2: What is the Model Number of Mechanical Cable Lugs?

A2: The Model Number of Mechanical Cable Lugs is DT and HUP.

Q3: Where is the place of origin of Mechanical Cable Lugs?

A3: The place of origin of Mechanical Cable Lugs is China.

Q4: What is the certification of Mechanical Cable Lugs?

A4: The certification of Mechanical Cable Lugs is UL, CUL and CE.

Q5: What is the minimum order quantity of Mechanical Cable Lugs?

A5: The minimum order quantity of Mechanical Cable Lugs is 1000.



TLC TERMINALS TECHNOLOGY LIMITED



+8615338876153



joe@t-terminals.com



cableslugs.com

4B Huafeng Industrial Park Baolong 1 Road Baolong Street, Longgang District, Shenzhen City