

## Ring Terminals SC Lugs Terminals Cable Lugs Non Insulated Copper Lugs 0.5-33mm<sup>2</sup> 22-8 AWG

Our Product Introduction

### Basic Information

- Place of Origin: China
- Brand Name: TLC
- Certification: UL certificates
- Model Number: SC
- Minimum Order Quantity: 1000
- Price: USD 0.01-5.99
- Packaging Details: carton
- Delivery Time: 1-5 weeks
- Payment Terms: T/T
- Supply Ability: 2KK pcs per month



### Product Specification

- Materials: Copper
- Plating: Tin
- Highlight: 33mm<sup>2</sup> Ring Cable Lugs,  
0.5mm<sup>2</sup> Ring Cable Lugs,  
Non Insulated Copper Lugs 0.5mm<sup>2</sup>

for more products please visit us on [cableslugs.com](http://cableslugs.com)

## Product Description

A non-insulated terminal is an electrical connector used to connect or secure a wire, which is usually made of metal material and does not have an insulating function. Non-insulated terminals are widely used in electrical and electronic equipment, automotive industry, home appliances and other fields.

Non-insulated terminals are usually made of conductive materials (such as copper, aluminum, etc.) and have good conductivity properties to achieve reliable electrical connections. They come in a variety of shapes and sizes, including round, flat, U-shaped, F-shaped, etc., to suit different connection needs. Non-insulated terminals can be bolted, crimped, or welded to the wire.



### Non-Insulated with Brazed Seam

## RING TERMINALS

Material  
Terminal Body: Copper  
Plating: Tin

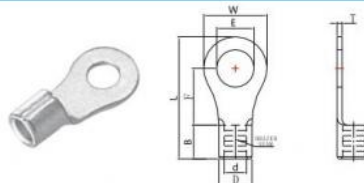

WIRE RANGE	STUD SIZE		ITEM NO	DIMENSION mm								P/N	QTY BOX
	mm <sup>2</sup> (A.W.G)	Metric American		E	W	F	L	B	D	d	T		
0.5-15 (22-16)	3	#4	RNB1-3.2	3.2	5.5	5.0	12.5					T-12091801	1000
	3.5	#6	RNBS1-3.7									T-12091802	
	3.5	#6	RNBM1-3.7	3.7	6.6	6.3	14.4					T-12091803	
	3.5	#6	RNBL1-3.7		8.0	7.0	15.8					T-12091804	
	4	#8	RNBS1-4		6.6	6.3	14.4					T-12091805	
	4	#8	RNBL1-4	4.3								T-12091806	
					8.0	7.0	15.8						
	5	#10	RNBS1-5								0.75	T-12091807	
	5	#10	RNBL1-5	5.3								T-12091808	
	6	1/4"	RNBS1-6		9.5	7.0	17.5	4.8	3.4	1.7		T-12091809	
	6	1/4"	RNBL1-6	6.4								T-12091810	
	8	5/16"	RNB1-8	8.4	11.6	11.0	21.8					T-12091811	
	10	3/8"	RNB1-10	10.5	13.6	13.9	25.5					T-12091812	
	12	1/2"	RNB1-12	13.0	19.2	16.0	30.4					T-12091813	
	14	9/16"	RNB1-14	15.0								T-12091814	
	16	5/8"	RNB1-16	17.0	27.0	21.0	39.3				0.8	T-12091815	
	20	3/4"	RNB1-20	21.0								T-12091816	
1.5-2.5 (16-14)	3	#4	RNB2-3.2	3.2		4.8	12.8					T-12091817	
	3.5	#6	RNBS2-3.7		6.6							T-12091818	
	3.5	#6	RNBM2-3.7	3.7		6.3	14.4	4.8	4.1	2.3	0.8	T-12091819	
	3.5	#6	RNBL2-3.7		8.5	7.4	16.5					T-12091820	
	4	#8	RNBS2-4	4.3	6.6	6.3	14.4					T-12091821	

## RING TERMINALS

**Material**  
Terminal Body: Copper  
Plating: Tin

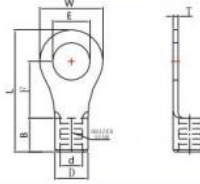

WIRE RANGE	STUD SIZE		ITEM NO	DIMENSION mm								P/N	QTY BOX
	mm2 (A.W.G)	Metric		American	E	W	F	L	B	D	d		
1.5-2.5 (16-14)	4	#8	RNBL2-4	4.3	8.5	7.4	16.5	4.8	4.1	2.3	0.8	T-12091822	1000
	5	#10	RNBS2-5	5.3								T-12091823	
	5	#10	RNBL2-5									T-12091824	
	6	1/4"	RNB2-6	6.4	12.0	11.0	21.8					T-12091825	
	8	5/16"	RNB2-8	8.4	12.0	11.0	21.8					T-12091826	
	10	3/8"	RNB2-10	10.5	13.6	13.9	25.5					T-12091827	
	12	1/2"	RNB2-12	13.0	19.2	16.0	30.4					T-12091828	
	14	9/16"	RNB2-14	15.0								T-12091829	
	16	5/16"	RNB2-16	17.0	27.0	21.0	39.3					T-12091830	
	20	3/4"	RNB2-20	21.0								T-12091831	
2.5-4 (14-12)	4	#8	RNB3-4	4.3	8.0	8.0	18.0	6.0	5.1	2.9	1.0	T-12091832	1000
	5	#10	RNBS3-5	5.3								T-12091833	
	5	#10	RNBL3-5		12.0	9.4	21.4					T-12091834	
	6	1/4"	RNB3-6	6.4								T-12091835	
	8	5/6"	RNB3-8	8.4	15.0	13.5	27.0					T-12091836	
4-6 (12-10)	3.5	#6	RNB5-3.7	3.7	7.2	6.1	15.7	6.0	5.6	3.4	1.0	T-12091837	1000
	4	#8	RNBS5-4	4.3								T-12091838	
	4	#8	RNBL5-4		9.5	6.1	15.7					T-12091839	
	5	#10	RNB5-5	5.3								T-12091840	
	6	1/4 "	RNB5-6	6.4	12.0	10.5	22.5					T-12091841	
	6	1/4"	RNB5-6			13.0	25.0					T-12091842	
	8	5/16 "	RNB5-8	8.4	15.0	13.3	27.0					T-12091843	
	10	3/8"	RNB5-10	10.5								T-12091844	