

## Tin Plated Copper Cable Lug Electrical Connections Copper Wire Lugs

Our Product Introduction

### Basic Information

- Place of Origin: China
- Brand Name: TLC
- Certification: UL, CUL, CE
- Model Number: TLK
- Minimum Order Quantity: 1000
- Price: USD
- Packaging Details: PE bag, Carton
- Delivery Time: 5-30 working days
- Payment Terms: T/T
- Supply Ability: 300-800K pcs per month



### Product Specification

- Material: Copper
- Application: Electrical Connections
- Product Name: Mechanical Cable Lugs
- MOQ: 1000 Pieces
- Current Rating: High
- Surface Treatment: Tin Plated
- Type: Crimped
- Packaging: Bag, Box, Carton
- Highlight: **Tin Plated Copper Cable Lug UL, Copper Cable Lug Electrical Connections, Electrical Connections Copper Wire Lugs UL**

for more products please visit us on [cableslugs.com](http://cableslugs.com)



### Non- Insulated - Copper Lugs

#### TLK LUGS TERMINALS

**Material**  
Terminal Body: Copper  
Plating: Tin

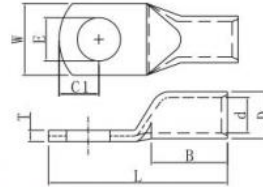

WIRE RANGE	STUD SIZE		ITEM NO	DIMENSION mm(inch)								P/N	QTY BOX
	mm2 (A.W.G)	Metric		E	D	d	W	B	C1	L	T		
6 (12-10)	5	#10	TLK 6-5	5.5	6.5	3.5	10.0	9.0	6.5	27.5	2.4	T-12095401	500
	6	1/4	TLK 6-6	6.5			12.0				1.9	T-12095402	
	8	5/16	TLK 6-8	8.4			15.0				1.5	T-12095403	
	10	3/8	TLK 6-10	10.5			17.0				1.3	T-12095404	
	12	1/2	TLK 6-12	13.0			19.0				1.2	T-12095405	
10 (8)	5	#10	TLK 10-5	5.5	7.0	4.6	12.0	10.0	6.5	28.5	1.8	T-12095406	500
	6	1/4	TLK 10-6	6.5			15.0				1.5	T-12095407	
	8	5/16	TLK 10-8	8.4			17.0				1.3	T-12095408	
	10	3/8	TLK 10-10	10.5			19.0				1.1	T-12095409	
	12	1/2	TLK 10-12	13.0			13.0				1.1	T-12095410	
16 (6)	5	#10	TLK 16-5	5.5	8.5	5.5	12.0	13.0	5.5	31.5	2.8	T-12095411	200
	6	1/4	TLK 16-6	6.5			15.0				2.1	T-12095412	
	8	5/16	TLK 16-8	8.4			17.0				2.0	T-12095413	
	10	3/8	TLK 16-10	10.5			19.0				1.5	T-12095414	
	12	1/2	TLK 16-12	13.0			12.0				1.5	T-12095415	
25 (4)	5	#10	TLK 25-5	5.5	10.0	7.0	14.0	15.0	7.5	37.5	2.8	T-12095416	200
	6	1/4	TLK 25-6	6.5			16.0				2.4	T-12095417	
	8	5/16	TLK 25-8	8.4			18.0				2.2	T-12095418	
	10	3/8	TLK 25-10	10.5			19.0				2.1	T-12095419	
	12	1/2	TLK 25-12	13.0			21.0				1.9	T-12095420	
	12	9/16	TLK 25-14	15.0			14.5				1.9	T-12095421	

## Product Description:

Lugs terminals are essential components in electrical systems. They are essential in providing a secure and reliable connection between wires and cables, and various electrical devices and equipment.

Lugs take the form of small metal connectors which are usually secured onto wires and terminals by crimping or soldering. This assures accuracy and safety, and they come in various sizes and shapes to optimally fit different wire gauges and terminal types.

## Features:

The **connection between lugs and terminals** is essential for ensuring a secure and stable electrical connection. This is particularly important when transferring either electrical power or electrical signals between two devices. In order to make sure that these connections are consistent, properly attaching lugs to terminals is necessary. Without a proper attachment, loose connections could lead to a decrease in performance, overheating, and, in extreme cases, even electrical failures.

## Technical Parameters:

Product Attribute	Description
-------------------	-------------

Type	Crimped
Product Name	Mechanical Cable Lugs
Material	Copper
Application	Electrical Connections
Color	Silver
Current Rating	High
Surface Treatment	Tin Plated
Packaging	Bag, Box, Carton
MOQ	1000 Pieces

## Applications:

Lugs terminals are indispensable in electrical systems, as they ensure secure and reliable connections between wires or cables and electrical devices or equipment.

Correct installation of lugs terminals is indispensable for optimal electrical performance and safety. Without applying the correct methods and techniques, the possibility of short circuits, reliability issues and other problems may arise.

For this reason, it is important to have an understanding of how lugs terminals should be installed and used, in order to make sure that their potential is fully realized.

## Support and Services:

Mechanical Cable Lugs Technical Support and Services

We offer comprehensive technical support and services for our Mechanical Cable Lugs. Our experienced and knowledgeable team of professionals can provide you with the best advice and solutions for your specific requirements.

We are dedicated to ensuring a high level of customer satisfaction and providing quality products and services. We strive to provide the highest possible standards of service and quality assurance.

Our technical support team is available to answer any questions you may have about our products. We can provide detailed product information, installation instructions, troubleshooting guidance and more. We also offer a range of after-sales services, including product repair and replacement.

We are committed to providing you with the highest quality products and services, and we look forward to working with you to create the perfect solution for your needs.

## Packing and Shipping:

Mechanical Cable Lugs Packaging and Shipping:

The mechanical cable lugs will be securely packaged in corrugated boxes.

The boxes will be taped shut and labeled with the product name and quantity.

The boxes will be shipped via a reputable courier service.

The courier service will handle all tracking and delivery of the packages.

## FAQ:

Q: What is the brand name?

A: The brand name is TLC.

Q: What is the model number?

A: The model number is TLK.

Q: Where is place of origin?

A: The place of origin is China.

Q: What certifications do these lugs have?

A: The lugs have UL, CUL, and CE certifications.

Q: What is the minimum order quantity?

A: The minimum order quantity is 1000.



**TLC TERMINALS TECHNOLOGY LIMITED**



+8615338876153



joe@t-terminals.com



cableslugs.com

4B Huafeng Industrial Park Baolong 1 Road Baolong Street, Longgang District, Shenzhen City