

## 35-240mm<sup>2</sup> Copper Tube Cable Lugs For Silver Connectors Non Insulated Copper Lug

Our Product Introduction

### Basic Information

- Place of Origin: China
- Brand Name: TLC
- Certification: UL, CUL, CE
- Model Number: KRS
- Minimum Order Quantity: 1000
- Price: USD
- Packaging Details: bag, carton package
- Delivery Time: 5-30 working days
- Payment Terms: T/T
- Supply Ability: 800K pcs per month



### Product Specification

- Color: Silver
- Shape: Round
- Application: Electrical Connections
- Package: Carton
- Material: Copper
- Product Name: Copper Tube Terminals
- Highlight: **35-240mm<sup>2</sup> copper tube lugs,  
35-240mm<sup>2</sup> Non Insulated Copper Lug,  
Non Insulated Copper Lug 35-240mm<sup>2</sup>**



for more products please visit us on [cableslugs.com](http://cableslugs.com)



## Non-Insulated - Copper Lugs

### TUBULAR LUGS TERMINALS

**Material**  
Terminal Body: Copper  
Plating: Tin

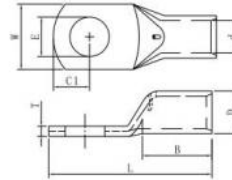

WIRE RANGE	STUD SIZE		ITEM NO	DIMENSION mm(inch)								P/N	QTY BOX
	mm2 (A.W.G)	Metric		E	D	d	W	B	C1	L	T		
35 (2)	6	1/4	KRS 35-6	6.4	11.6	9.0	15.0	22.0	9.0	47.0	3.0	T-12095101	100
	8	5/16	KRS 35-8	8.4								T-12095102	
	10	3/8	KRS 35-10	10.5								T-12095103	
50 (1/0)	6	1/4	KRS 50-6	6.4	14.1	11.0	18.0	24.0	10.0	48.5	3.5	T-12095104	
	8	5/16	KRS 50-8	8.4								T-12095105	
	10	3/8	KRS 50-10	10.5								T-12095106	
70 (2/0)	6	1/4	KRS 70-6	6.4	16.6	13.0	20.0	27.0	11.6	56.5	4.0	T-12095107	
	8	5/16	KRS 70-8	8.4								T-12095108	
	10	3/8	KRS 70-10	10.5								T-12095109	
95 (3/0)	8	5/16	KRS 95-8	8.4	19.6	15.0	24.0	30.0	14.5	68.5	5.0	T-12095110	
	10	3/8	KRS 95-10	10.5								T-12095111	
	12	1/2	KRS 95-12	13.0								T-12095112	
120 (4/0)	8	5/16	KRS 120-8	8.4	22.0	17.0	26.0	31.5	15.0	72.5	5.6	T-12095113	
	10	3/8	KRS 120-10	10.5								T-12095114	
	12	1/2	KRS 120-12	13.0								T-12095115	
150 (250/300)	10	3/8	KRS 150-10	10.5	24.6	19.0	30.0	37.0	15.0	80.0	6.0	T-12095116	
	12	1/2	KRS 150-12	13.0								T-12095117	
180 (300/500)	10	3/8	KRS 185-10	10.5	27.6	21.0	32.0	42.0	15.0	86.0	7.0	T-12095118	
	12	1/2	KRS 185-12	13.0								T-12095119	
	16	5/8	KRS 185-16	17.0								T-12095120	
240 (400/545)	10	3/8	KRS 240-10	10.5	29.4	22.5	38.0	43.0	17.0	94.5	7.5	T-12095121	
	12	1/2	KRS 240-12	13.0								T-12095122	
	16	5/8	KRS 240-16	17.0								T-12095123	

## Product Description:

Lugs Terminals: For a Secure and Reliable Connection

Lugs terminals are important components for any electrical system. They are used to provide reliable and secure connection between wires/cables and electrical devices or equipment. Correct installation of lugs terminals is essential to achieve optimal electrical performance and protection from potential hazards.

The importance of properly installed terminals is critical for the efficient distribution of electrical power or signals from one device to another. This in turn affects the overall performance of electrical systems in terms of safety and reliability.

For safety and best practices, it is recommended to choose the appropriate size, type and rating of lug terminals for the intended application. Learning how to properly install electrical lugs terminal is really worthwhile, as this guarantees an optimum electrical performance and protection from potential threats.

## Features:

Lugs terminals are essential components in electrical systems, as they create secure and reliable connections between wires and cables and the corresponding electrical devices or equipment.

Lugs are small metal connectors that come in various shapes and sizes. Depending on the wire gauge and type of terminal, the appropriate size and shape of lug must be chosen to ensure a reliable connection. The lugs are crimped or soldered on the ends of wires to provide a secure electrical connection.

## Applications:

The connection produced by lugs and terminals is advantageous in many aspects. A combination of lugs and terminals guarantees a reliable and solid electrical connection. This is necessary for successful exchange of electrical power or signals between two devices. Installed lugs and terminals carefully can help reduce the chance of inadequate junction, and eventually blocking of performance, overheating, and also electric failures.

## Support and Services:

At Copper Tube Terminals, we strive to provide our customers with the highest quality technical support and services. We have a dedicated team of experienced professionals who are available to answer any questions and provide assistance with any product-related issues. Additionally, we provide an online support center where customers can access tutorials, FAQs, and other helpful resources. Our team is available to provide additional support by telephone, email, or live chat. We also have a comprehensive repair service where we can diagnose and repair any issues that may arise with your Copper Tube Terminals product. Furthermore, we offer a customer satisfaction guarantee on all of our products, ensuring that you are fully satisfied with your purchase.

## Packing and Shipping:

Packaging and Shipping for Copper Tube Terminals:

The copper tube terminals will be packed in standard cartons, with each carton containing no more than 1,000 terminals. The cartons will be securely sealed and clearly labelled with the contents and weight of the carton. The terminals will be shipped via ground transportation to ensure the safe and timely delivery of the products.

## FAQ:

Q: What is the brand name of the Copper Tube Terminals?

A: The brand name of the Copper Tube Terminals is TLC.

Q: What is the model number of the Copper Tube Terminals?

A: The model number of the Copper Tube Terminals is TYF and T.

Q: Where does the Copper Tube Terminals come from?

A: The Copper Tube Terminals come from China.

Q: What certifications do the Copper Tube Terminals have?

A: The Copper Tube Terminals have UL, CUL and CE certifications.

Q: How many Copper Tube Terminals can I order at minimum?

A: The minimum order quantity for Copper Tube Terminals is 1000.



**TLC TERMINALS TECHNOLOGY LIMITED**



+8615338876153



joe@t-terminals.com



cableslugs.com

4B Huafeng Industrial Park Baolong 1 Road Baolong Street, Longgang District, Shenzhen City