

Silver 180D Copper Tube Lug For Electrical Connector SC YK Terminal Lug 16-95mm2

Our Product Introduction

Basic Information

- Place of Origin: China
- Brand Name: TLC
- Certification: UL, CUL, CE
- Model Number: SC
- Minimum Order Quantity: 1000 pcs
- Price: USD
- Packaging Details: Carton
- Delivery Time: 5-30 days
- Payment Terms: T/T
- Supply Ability: 500 - 1000 K PCS



Product Specification

- Color: Silver
- Cable Range: 10-95mm2
- Direction: 180D
- Material: Copper
- Tin Plated: Yes
- Temperature Range: -40 ~+105
- Highlight: Silver 180D Copper Tube Lug,
16mm2 Copper Tube Lug Electrical Connector,
sc cable lug 95mm2

for more products please visit us on cableslugs.com



Non- Insulated - Copper Lugs

SC-YK LUGS TERMINALS

Material
Terminal Body: Copper
Plating: Tin

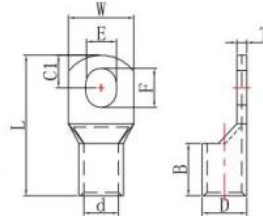

WIRE RANGE	STUD SIZE		ITEM NO	DIMENSION mm(inch)										P/N	QTY BOX			
	mm2 (A.W.G)	Metric		American	E	D	d	W	F	B	C1	L	T					
16 (6)	6	1/4	SC 16-6-YK	6.4	7.5	5.8	12.5	8.0	11.4	6.5	30.0	1.6	T-12135101	500				
	8	5/16	SC 16-8-YK	8.4			10.5	T-12135102										
	10	3/8	SC 16-10-YK	10.5			14.0	12.0					7.0		1.2	T-12135103		
25 (4)	5	#10	SC25-5-YKL	5.3	9.5	7.5	14.0	7.5	12.0	8.0	35.0	1.9	T-12135104	200				
	6	1/4	SC 25-6-YKL	6.4			7.5	14.0					8.0		T-12135105			
	6	1/4	SC 25-6-YK				9.0	7.2					13.4		8.0	33.0	T-12135106	
	8	5/16	SC25-8-YKL				9.5	7.5					15.0		10.5	35.0	1.8	T-12135107
	8	5/16	SC 25-8-YK				8.4	9.0					7.2		13.4	10.5	33.0	T-12135108
35 (2)	4	#8	SC 35-4-YK	4.5	11.0	8.5	15.0	7.5	14.0	8.5	36.0	2.4	T-12135109	200				
	6	1/4	SC 35-6-YK	6.4	10.5	8.2	15.5	8.0	13.5	9.0	38.0	2.1	T-12135110					
	8	5/16	SC 35-8-YKL	8.4	10.5	8.3	15.8	12.0	15.3	10.0	46.0	2.1	T-12135111					
	8	5/16	SC 35-8-YK	8.4	11.4	8.6	16.5	10.5	15.0	8.5	38.0	2.6	T-12135112					
	10	3/8	SC 35-10-YK	10.5	10.5	8.5	15.5	12.0	14.0	9.0	38.0	2.2	T-12135113					
50 (1/0)	6	1/4	SC 50-6-YK	6.4	12.5	9.5	18.0	8.0	16.0	10.0	44.0	2.9	T-12135114	100				
	8	5/16	SC 50-8-YK	8.4				10.5					T-12135115					
	10	3/8	SC 50-10-YK	10.5				12.0					16.5		11.0	45.0	2.5	T-12135116
70 (2/0)	6	1/4	SC 70-6-YK	6.4	15.0	12.0	22.0	8.0	17.0	12.0	50.0	3.0	T-12135117	50				
	8	5/16	SC 70-8-YK	8.4				10.5	19.0				T-12135118					
	10	3/8	SC 70-10-YK	10.5				12.0	19.0				T-12135119					
95 (3/0)	8	5/16	SC95-8-YK	8.4	17.5	13.5	25	13.8	23	12.5	58	3.8	T-12135126	30				
	10	3/8	SC95-10-YK	10.5									T-12135123					

Product Description:

Lugs terminals are an essential component in electrical systems, playing a critical role in the secure and reliable connection between wires or cables and electrical devices or equipment. It is vital that they are properly installed in order to guarantee optimal electrical performance and safety.

Without proper installation, lugs terminals cannot perform their task of connecting electrical components together properly. It is thus very important that they are properly fitted and secured.

The use of lugs terminals can provide significant advantages in terms of reliability and longevity. They are designed to be strong and durable, providing robust connections which can easily withstand the knocks and vibrations of daily life. In addition, lugs terminals provide a much simpler and faster way to make and break connections between wires or cables and electrical components.

Features:

Lugs and terminals come together to form a strong and fixed electrical connection, which ensures the effective transmission of electrical energy or signals between any two electronic devices. This strong and stable electrical link is a must-have in any electrical system, and it is fundamental in order to ensure stability, to avoid loose connections that lead to failure or overheating.

Installing lugs and terminals correctly, as well as regularly checking the connections, is essential to keeping the electrical system working at its full potential. Occasionally checking the connections helps to maintain the optimal performance, avoiding issues that could eventually make the system malfunction.

Applications:

Lugs Terminals are essential components for all electrical systems. Through their ability to connect wires or cables to different electrical devices, they play an important role in the development and operation of such systems. Essentially, lugs are small metal connectors to fasten onto the ends of wires. This ensures that a secure and reliable connection is established between the terminal and the lug. Furthermore, there is a wide selection of lugs available in different sizes and shapes to suit different wire gauges and terminal types.

Support and Services:

Tubular Cable Lugs Technical Support and Service

We provide technical support and service for our Tubular Cable Lug products. Our team of trained professionals are available to answer any questions you may have about our products and help you identify the best solution for your application. We have an extensive knowledge base of product information, installation instructions, and troubleshooting tips to help you find the answers you need to get the job done.

We also offer a variety of services, including on-site installation, custom fabrication, and repair. Our experienced technicians can install your Tubular Cable Lug products quickly and correctly, ensuring that your application runs smoothly and efficiently. We can also fabricate custom lugs to meet your specific needs, and can repair any damaged or worn parts.

If you have any questions or would like to find out more about our Tubular Cable Lug products and services, please feel free to contact us anytime. We look forward to hearing from you!

Packing and Shipping:

Packaging and Shipping for Tubular Cable Lugs

Tubular cable lugs are packaged in either cartons or bags, depending on the size and quantity of the order. They are then placed in boxes and secured with bubble wrap or foam for extra protection. All orders are shipped via standard ground shipping with tracking provided, but expedited shipping is available upon request.

FAQ:

Q: What is the Brand Name of the product?

A: The Brand Name of the product is TLC.

Q: What is the Model Number of the product?

A: The Model Number of the product is SC.

Q: Where is the product made?

A: The product is made in China.

Q: What are the certifications of the product?

A: The product is certified with UL, CUL, CE.

Q: What is the Minimum Order Quantity of the product?

A: The Minimum Order Quantity of the product is 1000 pcs.



TLC TERMINALS TECHNOLOGY LIMITED



+8615338876153



joe@t-terminals.com



cableslugs.com

4B Huafeng Industrial Park Baolong 1 Road Baolong Street, Longgang District, Shenzhen City