

## Silver Electrical Tube Connector 6-25mm<sup>2</sup> Crimping Copper Terminals

Our Product Introduction

### Basic Information

- Place of Origin: China
- Brand Name: TLC
- Certification: UL, CUL, CE
- Model Number: TLK
- Minimum Order Quantity: 1000
- Price: USD
- Packaging Details: bag, carton package
- Delivery Time: 5-30 working days
- Payment Terms: T/T
- Supply Ability: 800K pcs per month



### Product Specification

- Shape: Round
- Material: Copper
- Package: Carton
- Product Name: Copper Tube Terminals
- Application: Electrical Connections
- Color: Silver
- Highlight: **Silver Electrical Tube Connector 6mm<sup>2</sup>,  
Silver Electrical Tube Connector 25mm<sup>2</sup>,  
25mm<sup>2</sup> Crimping Copper Terminals**

for more products please visit us on [cableslugs.com](http://cableslugs.com)



## Non- Insulated - Copper Lugs

### TLK LUGS TERMINALS

**Material**  
Terminal Body: Copper  
Plating: Tin

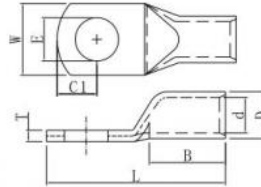

WIRE RANGE	STUD SIZE		ITEM NO	DIMENSION mm(inch)								P/N	QTY BOX
	mm2 (A.W.G)	Metric		E	D	d	W	B	C1	L	T		
6 (12-10)	5	#10	TLK 6-5	5.5	6.5	3.5	10.0	9.0	6.5	27.5	2.4	T-12095401	500
	6	1/4	TLK 6-6	6.5			12.0				1.9	T-12095402	
	8	5/16	TLK 6-8	8.4			15.0				1.5	T-12095403	
	10	3/8	TLK 6-10	10.5			17.0				1.3	T-12095404	
	12	1/2	TLK 6-12	13.0			19.0				1.2	T-12095405	
10 (8)	5	#10	TLK 10-5	5.5	7.0	4.6	12.0	10.0	6.5	28.5	1.8	T-12095406	500
	6	1/4	TLK 10-6	6.5			15.0				1.5	T-12095407	
	8	5/16	TLK 10-8	8.4			17.0				1.3	T-12095408	
	10	3/8	TLK 10-10	10.5			19.0				1.1	T-12095409	
	12	1/2	TLK 10-12	13.0			13.0				1.1	T-12095410	
16 (6)	5	#10	TLK 16-5	5.5	8.5	5.5	12.0	13.0	5.5	31.5	2.8	T-12095411	200
	6	1/4	TLK 16-6	6.5			15.0				2.1	T-12095412	
	8	5/16	TLK 16-8	8.4			17.0				2.0	T-12095413	
	10	3/8	TLK 16-10	10.5			19.0				1.5	T-12095414	
	12	1/2	TLK 16-12	13.0			12.0				1.5	T-12095415	
25 (4)	5	#10	TLK 25-5	5.5	10.0	7.0	14.0	15.0	7.5	37.5	2.8	T-12095416	200
	6	1/4	TLK 25-6	6.5			16.0				2.4	T-12095417	
	8	5/16	TLK 25-8	8.4			18.0				2.2	T-12095418	
	10	3/8	TLK 25-10	10.5			19.0				2.1	T-12095419	
	12	1/2	TLK 25-12	13.0			21.0				1.9	T-12095420	
	12	9/16	TLK 25-14	15.0			14.5				1.9	T-12095421	

## Product Description:

Having a strong and stable electrical connection is essential for the successful transmission of electrical power or signals between devices. This can be achieved through lugs and terminals, as they work together to provide a reliable connection. If not installed properly, loose connections will form, causing a range of issues such as poor performance and even electrical failure. Consequently, it is important to ensure that lugs and terminals are correctly installed to prevent any of these issues.

## Technical Parameters:

Property	Value
Product Name	Copper Tube Terminals
Package	Carton
Color	Silver
Shape	Round
Material	Copper

Property	Value
Application	Electrical Connections
Keywords	Tube Terminal Lug, Copper Tube Terminals, high power tube cable lug

## Applications:

Tube cable lugs are small metal connectors used to secure and provide a reliable connection to terminals. These lugs come in various sizes and shapes in order to accommodate a range of different wire gauges and terminals. To use them, they need to be crimped or soldered onto the wires.

These lugs are an essential component of any electricity system and can help to make sure power is distributed safely and securely. They are usually designed to handle a range of environments, temperatures and materials. This means that they can be used over multiple jobs, from home wiring to heavy-duty, industrial applications.

## Customization:

Copper Tube Terminals

Brand Name: TLC

Place of Origin: China

Certification: UL, CUL, CE

Minimum Order Quantity: 1000

Price: USD

Packaging Details: Bag, Carton Package

Delivery Time: 5-30 Working Days

Payment Terms: T/T

Supply Ability: 800K pcs Per Month

Material: Copper

Application: Electrical Connections

Color: Silver

Shape: Round

Package: Carton

TLC Copper Tube Terminals are perfect for new energy tube cable lug, Tube Terminal Lug, and other electrical connections.

## Support and Services:

Technical Support and Service for Copper Tube Terminals

We offer expert technical support and service for Copper Tube Terminals. Our team of highly trained technicians can provide you with installation, troubleshooting, and maintenance support for your Copper Tube Terminals. We understand the importance of having a reliable and efficient system and are dedicated to providing you with the highest quality service.

We offer comprehensive service plans to meet your needs, including on-site maintenance, periodic inspections, and on-call emergency support. Our technicians are available 24/7 and are always ready to respond to your service needs. We also provide product training to ensure that your Copper Tube Terminals are used correctly and safely.

If you have any questions about our services, please don't hesitate to contact us. We are always happy to answer any questions you may have and help you find the best solution for your Copper Tube Terminals.

## Packing and Shipping:

Packaging and Shipping for Copper Tube Terminals

Copper Tube Terminals are typically packaged in a corrugated box with a polyethylene bag inside for added protection. This helps to keep the terminals safe during shipping, and ensures that they are not damaged or scratched during transit.

The box should be clearly labeled with the product name and any relevant shipment information. This will help to ensure that the terminals arrive at the correct destination on time.

The box should be securely sealed with packaging tape, and the package should be labeled with a shipping address. The package should also be insured for any potential damages that may occur during transit.

## FAQ:

**Q: What is the brand name of the Copper Tube Terminals?**

A: The brand name of the Copper Tube Terminals is TLC.

**Q: Where is the Copper Tube Terminals manufactured?**

A: The Copper Tube Terminals is manufactured in China.

**Q: What certifications does the Copper Tube Terminals have?**

A: The Copper Tube Terminals has UL, CUL, and CE certifications.

**Q: What is the minimum order for the Copper Tube Terminals?**

A: The minimum order for the Copper Tube Terminals is 1000 pieces.

**Q: How much does the Copper Tube Terminals cost?**

A: The cost of the Copper Tube Terminals is USD.

**Q: How is the Copper Tube Terminals packaged?**

A: The Copper Tube Terminals is packaged in bags and cartons.

**Q: How long will it take to receive an order of Copper Tube Terminals?**

A: It will take 5-30 working days to receive an order of Copper Tube Terminals.

**Q: What payment methods are accepted for the Copper Tube Terminals?**

A: Payment for the Copper Tube Terminals is accepted via T/T.

**Q: What is the supply ability for the Copper Tube Terminals?**

A: The supply ability for the Copper Tube Terminals is 800K pcs per month.



**TLC TERMINALS TECHNOLOGY LIMITED**



+8615338876153



joe@t-terminals.com



cableslugs.com

4B Huafeng Industrial Park Baolong 1 Road Baolong Street, Longgang District, Shenzhen City