

Copper Cable Lug Connectors Nylon Insulation Terminal Lug Connector

Our Product Introduction

Basic Information

- Place of Origin: CHINA
- Brand Name: TLC
- Certification: UL
- Model Number: FDNYD
- Minimum Order Quantity: 1000
- Price: USD0.01-2.00
- Packaging Details: RAIL AND CARTONS
- Delivery Time: 1-4 WEEKS
- Payment Terms: T/T
- Supply Ability: 1KK PCS PER MONTH



Product Specification

- Insulation: Nylon
- Terminal Body: Brass
- Metallic Sleeve: Copper
- Plating: Tin
- Highlight: Copper Cable Lug Connectors UL ,
Terminal Lug Connector UL,
Nylon Insulation Terminal Lug Connector

for more products please visit us on cableslugs.com

Product Description

A non-insulated terminal is an electrical connector used to connect or secure a wire, which is usually made of metal material and does not have an insulating function. Non-insulated terminals are widely used in electrical and electronic equipment, automotive industry, home appliances and other fields.

Non-insulated terminals are usually made of conductive materials (such as copper, aluminum, etc.) and have good conductivity properties to achieve reliable electrical connections. They come in a variety of shapes and sizes, including round, flat, U-shaped, F-shaped, etc., to suit different connection needs. Non-insulated terminals can be bolted, crimped, or welded to the wire.



Non-Insulated with Brazed Seam

RING TERMINALS

Material
Terminal Body: Copper
Plating: Tin

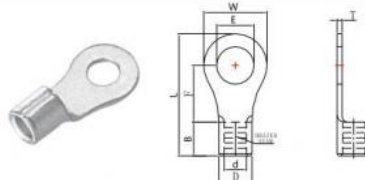

| WIRE RANGE | STUD SIZE | | ITEM NO | DIMENSION mm | | | | | | | | P/N | QTY BOX |
|--------------------|----------------------------|-----------------|-----------|--------------|------|------|------|-----|-----|-----|------|------------|---------|
| | mm ² (A.W.G) | Metric American | | E | W | F | L | B | D | d | T | | |
| 0.5-15 (22-16) | 3 | #4 | RNB1-3.2 | 3.2 | 5.5 | 5.0 | 12.5 | | | | | T-12091801 | 1000 |
| | 3.5 | #6 | RNBS1-3.7 | | | | | | | | | T-12091802 | |
| | 3.5 | #6 | RNBM1-3.7 | 3.7 | 6.6 | 6.3 | 14.4 | | | | | T-12091803 | |
| | 3.5 | #6 | RNBL1-3.7 | | 8.0 | 7.0 | 15.8 | | | | | T-12091804 | |
| | 4 | #8 | RNBS1-4 | | 6.6 | 6.3 | 14.4 | | | | | T-12091805 | |
| | 4 | #8 | RNBL1-4 | 4.3 | | | | | | | | T-12091806 | |
| | | | | | 8.0 | 7.0 | 15.8 | | | | | | |
| | 5 | #10 | RNBS1-5 | | | | | | | | 0.75 | T-12091807 | |
| | 5 | #10 | RNBL1-5 | 5.3 | | | | | | | | T-12091808 | |
| | 6 | 1/4" | RNBS1-6 | | 9.5 | 7.0 | 17.5 | 4.8 | 3.4 | 1.7 | | T-12091809 | |
| | 6 | 1/4" | RNBL1-6 | 6.4 | | | | | | | | T-12091810 | |
| | 8 | 5/16" | RNB1-8 | 8.4 | 11.6 | 11.0 | 21.8 | | | | | T-12091811 | |
| | 10 | 3/8" | RNB1-10 | 10.5 | 13.6 | 13.9 | 25.5 | | | | | T-12091812 | |
| | 12 | 1/2" | RNB1-12 | 13.0 | 19.2 | 16.0 | 30.4 | | | | | T-12091813 | |
| | 14 | 9/16" | RNB1-14 | 15.0 | | | | | | | | T-12091814 | |
| | 16 | 5/8" | RNB1-16 | 17.0 | 27.0 | 21.0 | 39.3 | | | | 0.8 | T-12091815 | |
| | 20 | 3/4" | RNB1-20 | 21.0 | | | | | | | | T-12091816 | |
| 1.5-2.5 (16-14) | 3 | #4 | RNB2-3.2 | 3.2 | | 4.8 | 12.8 | | | | | T-12091817 | |
| | 3.5 | #6 | RNBS2-3.7 | | 6.6 | | | | | | | T-12091818 | |
| | 3.5 | #6 | RNBM2-3.7 | 3.7 | | 6.3 | 14.4 | 4.8 | 4.1 | 2.3 | 0.8 | T-12091819 | |
| | 3.5 | #6 | RNBL2-3.7 | | 8.5 | 7.4 | 16.5 | | | | | T-12091820 | |
| | 4 | #8 | RNBS2-4 | 4.3 | 6.6 | 6.3 | 14.4 | | | | | T-12091821 | |

RING TERMINALS

Material
Terminal Body: Copper
Plating: Tin

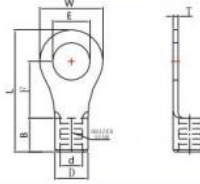

| WIRE RANGE | STUD SIZE | | ITEM NO | DIMENSION mm | | | | | | | | P/N | QTY BOX | | | | |
|-----------------|-------------|--------|----------|--------------|------|------|------|-----|-----|-----|-----|------------|---------|---|--|--|--|
| | mm2 (A.W.G) | Metric | | American | E | W | F | L | B | D | d | | | T | | | |
| 1.5-2.5 (16-14) | 4 | #8 | RNBL2-4 | 4.3 | 8.5 | 7.4 | 16.5 | 4.8 | 4.1 | 2.3 | 0.8 | T-12091822 | 1000 | | | | |
| | 5 | #10 | RNBS2-5 | 5.3 | | | | | | | | T-12091823 | | | | | |
| | 5 | #10 | RNBL2-5 | 5.3 | | | | | | | | T-12091824 | | | | | |
| | 6 | 1/4" | RNB2-6 | 6.4 | 12.0 | 11.0 | 21.8 | | | | | T-12091825 | | | | | |
| | 8 | 5/16" | RNB2-8 | 8.4 | 12.0 | 11.0 | 21.8 | | | | | T-12091826 | | | | | |
| | 10 | 3/8" | RNB2-10 | 10.5 | 13.6 | 13.9 | 25.5 | | | | | T-12091827 | | | | | |
| | 12 | 1/2" | RNB2-12 | 13.0 | 19.2 | 16.0 | 30.4 | | | | | T-12091828 | | | | | |
| | 14 | 9/16" | RNB2-14 | 15.0 | | | | | | | | T-12091829 | | | | | |
| | 16 | 5/16" | RNB2-16 | 17.0 | 27.0 | 21.0 | 39.3 | | | | | T-12091830 | | | | | |
| | 20 | 3/4" | RNB2-20 | 21.0 | | | | | | | | T-12091831 | | | | | |
| 2.5-4 (14-12) | 4 | #8 | RNB3-4 | 4.3 | 8.0 | 8.0 | 18.0 | 6.0 | 5.1 | 2.9 | 1.0 | T-12091832 | 1000 | | | | |
| | 5 | #10 | RNBS3-5 | 5.3 | | | | | | | | T-12091833 | | | | | |
| | 5 | #10 | RNBL3-5 | 5.3 | 12.0 | 9.4 | 21.4 | | | | | T-12091834 | | | | | |
| | 6 | 1/4" | RNB3-6 | 6.4 | | | | | | | | T-12091835 | | | | | |
| | 8 | 5/6" | RNB3-8 | 8.4 | 15.0 | 13.5 | 27.0 | | | | | T-12091836 | | | | | |
| 4-6 (12-10) | 3.5 | #6 | RNB5-3.7 | 3.7 | 7.2 | 6.1 | 15.7 | 6.0 | 5.6 | 3.4 | 1.0 | T-12091837 | 1000 | | | | |
| | 4 | #8 | RNBS5-4 | 4.3 | | | | | | | | T-12091838 | | | | | |
| | 4 | #8 | RNBL5-4 | 4.3 | 9.5 | 6.1 | 15.7 | | | | | T-12091839 | | | | | |
| | 5 | #10 | RNB5-5 | 5.3 | | | | | | | | T-12091840 | | | | | |
| | 6 | 1/4 " | RNB5-6 | 6.4 | 12.0 | 10.5 | 22.5 | | | | | T-12091841 | | | | | |
| | 6 | 1/4" | RNB5-6 | 6.4 | | | | | | | | T-12091842 | | | | | |
| | 8 | 5/16 " | RNB5-8 | 8.4 | 15.0 | 13.3 | 27.0 | | | | | T-12091843 | | | | | |
| | 10 | 3/8" | RNB5-10 | 10.5 | | | | | | | | T-12091844 | | | | | |