

Silver Tubular Cable Lugs -40C~+105C Temperature Range 0.5-10mm² Tube Terminal Lugs Copper Lugs

Our Product Introduction

Basic Information

- Place of Origin: China
- Brand Name: TLC
- Certification: UL, CUL, CE
- Model Number: SC
- Minimum Order Quantity: 1000 pcs
- Price: USD
- Packaging Details: Carton
- Delivery Time: 5-30 days
- Payment Terms: T/T
- Supply Ability: 500 - 1000 K PCS



Product Specification

- Color: Silver
- Tin Plated: Yes
- Cable Range: 0.5-300mm²
- Temperature Range: -40 ~+105
- Material: Copper
- Direction: 180D, 45D, 90D, 135D
- Highlight: **Silver Tubular Cable Lugs -40C,**
Silver Tubular Cable Lugs +105C,
electrical wire lugs 10mm²



for more products please visit us on cableslugs.com



Non- Insulated - Copper Lugs

SC LUGS TERMINALS

Material
Terminal Body: Copper
Plating: Tin

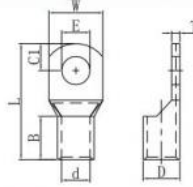

WIRE RANGE	STUD SIZE		ITEM NO	DIMENSION mm								P/N	QTY BOX
	mm2 (A.W.G)	Metric		E	D	d	W	B	C1	L	T		
0.5-1.5 (22-16)	4	#8	SC1.5 - 4	4.3	4.0	2.0	8.0	5.0	4.5	16.5	1.00	T-12131101	1000
	5	#10	SC1.5 - 5	5.3			8.0		4.5	16.5	1.00	T-12131102	
	6	1/4	SC1.5 - 6	6.4			8.0		4.5	16.5	1.00	T-12131103	
1.5-2.5 (16-14)	4	#8	SC2.5 - 4	4.3	4.5	2.9	8.0	7.0	4.5	19.0	1.10	T-12131104	
	5	#10	SC2.5 - 5	5.3			8.0		5.0	21.0	1.05	T-12131105	
	6	1/4	SC2.5 - 6	6.4			10.0		5.0	21.0	1.00	T-12131106	
	8	5/16	SC2.5 - 8	8.4			13.0		6.5	24.0	0.88	T-12131107	
2.5-4 (14-12)	4	#8	SC4 - 4	4.3	5.2	3.6	10.0	7.0	5.0	21.0	1.00	T-12131108	
	5	#10	SC4 - 5	5.2			10.0		5.0	21.0	1.00	T-12131109	
	6	1/4	SC4 - 6	6.5			10.0		5.0	21.0	1.00	T-12131110	
	8	5/16	SC4 - 8	8.4			13.0		6.0	24.0	0.80	T-12131111	
4-6 (12-10)	4	#8	SC6-4	4.3	5.5	3.8	10.5	10.0	5.5	24.0	1.15	T-12131112	
	5	#10	SC6 - 5	5.3			10.5		5.5	24.0	1.15	T-12131113	
	6	1/4	SC6 - 6	6.4			11.0		5.5	24.5	1.10	T-12131114	
	8	5/16	SC6 - 8	8.4			12.0		6.5	26.5	1.00	T-12131115	
10 (8)	4	#8	SC10-4	4.3	6.5	4.9	12.0	10.0	5.5	25.0	1.20	T-12131116	
	5	#10	SC10 - 5	5.3			12.0		5.5	25.0	1.20	T-12131117	
	6	1/4	SC10 - 6	6.4			12.0		5.5	25.0	1.20	T-12131118	
	8	5/16	SC10 - 8	8.4			12.5		6.5	27.0	1.15	T-12131119	
	10	3/8	SC10- 10	10.5	7.0	5.0	18.0		10.0	34.5	0.93	T-12131120	
	12	1/2	SC10 - 12	13.0			18.5		13.0	39.5	0.90	T-12131121	

SC LUGS TERMINALS

Material
Terminal Body: Copper
Plating: Tin

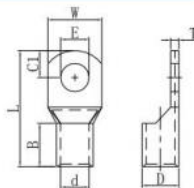

WIRE RANGE	STUD SIZE		ITEM NO	DIMENSION mm								P/N	QTY BOX
	mm2 (A.W.G)	Metric		Amerian	E	D	d	W	B	C1	L		
16 (6)	4	#8	SC16 - 4	4.3	7.5	5.8	12.2	11.4	6.5	30.0	1.6	T-12131122	500
	5	#10	SC16 - 5	5.4								T-12131123	
	6	1/4	SC16 - 6	6.4								T-12131124	
	8	5/16	SC16 - 8	8.4			T-12131125						
	10	3/8	SC16 - 10	10.5			14.0	7.0	1.26	T-12131126			
25 (4)	5	#10	SC25-5(13)	5.3	9.5	9.0	13.0	12.0	8.0	32.0	1.7	T-12131127	200
	6	1/4	SC25 - 6(13)	6.4								T-12131128	
	8	5/16	SC25 - 8(13)	8.4								T-12131129	
	4	#8	SC25-4	4.2		13.8	12.0	7.8	35.0	1.9	T-12131130		
	5	#10	SC25-5	5.3							T-12131131		
	6	1/4	SC25 - 6	6.4							T-12131132		
	8	5/16	SC25 - 8	8.4							1.8	T-12131133	
	10	3/8	SC25 - 10	10.5								T-12131134	
	12	1/2	SC25 - 12	13.0								T-12131135	
35 (2)	6	1/4	SC35 - 6	6.4	10.8	8.5	15.7	14.0	8.0	37.0	2.2	T-12131136	200
	8	5/16	SC35 - 8	8.4								T-12131137	
	10	3/8	SC35 - 10	10.5								T-12131138	
	12	1/2	SC35 - 12	13.0	10.5	8.3	18.7	15.5	9.0	38.0	1.7	T-12131139	
	6	1/4	SC35 - 6-GTNR	6.4	11.3	8.7	16.5	15.0	9.0	38.0	2.6	T-12131140	
	8	5/16	SC35 - 8-GTNR	8.4								T-12131141	
	10	3/8	SC35 - 10-GNTR	10.5								39.0	

Product Description:

Lugs terminals are of great significance in electrical systems, **for they** enable secure and dependable connections to be established between wires or cables and electrical devices or equipment. Their accurate installation is indispensable for the best electrical performance and guarantees maximum safety.

Features:

Installing Lugs and Terminals

A successful electrical connection requires the use of lugs and terminals. This is vital for the smooth exchange of electrical power or signals between components. Proper installation of these components is essential to avoid any loose connections, which could lead to overheating, underperformance, or even electrical malfunctions.

The combination of lugs and terminals helps create a sturdy connection, allowing for uninterrupted work. It is important to ensure that these are properly secured in order to obtain a strong and dependable electrical link. Doing so reduces the possibility of failure and gives users an assurance of reliability.

Applications:

Lugs terminals are essential components in electrical systems, which play a crucial role for connecting wires or cables to various electrical devices or equipment.

In order to do that, lugs, small metal connectors, are designed to provide a secure and reliable connection to terminals. Each lug is equipped suitable for crimped or soldered onto the ends of wires according to different wire gauges and terminal types.

Support and Services:

Technical Support & Services for Tubular Cable Lugs

We provide reliable and professional technical support and services for our Tubular Cable Lugs.
We will provide technical consultation to identify the best solution for your application.
We offer installation instructions and after-sales service.
We guarantee a fast response time to all inquiries.
We provide free product samples and trial samples.
We have experienced engineers to provide technical support.
We provide free warranty repair services.

Packing and Shipping:

Tubular Cable Lugs are packaged and shipped in pre-cut lengths to meet customer requirements. The tubes are securely packed in corrugated cardboard boxes with foam inserts to protect the product. The boxes are labeled with product information and shipped via courier or airfreight.

The product is shipped in a fully assembled state, ready for installation. All products are tested and inspected before shipping to ensure that they are in top condition before leaving the warehouse.

For international orders, we provide additional packaging and shipping services to ensure the safe and secure delivery of Tubular Cable Lugs to their final destination.

FAQ:

Q1: What is Tubular Cable Lugs?

A1: Tubular Cable Lugs are electrical cable connectors from TLC, with model number SC.

Q2: Where is Tubular Cable Lugs from?

A2: Tubular Cable Lugs are made in China.

Q3: What certifications do Tubular Cable Lugs have?

A3: Tubular Cable Lugs have UL, CUL and CE certifications.

Q4: How many Tubular Cable Lugs can I order?

A4: The minimum order quantity for Tubular Cable Lugs is 1000 pcs.

Q5: How much do Tubular Cable Lugs cost?

A5: The price of Tubular Cable Lugs is USD, and it will be packed in cartons. Delivery time is 5-30 days and payment terms is T/T. The supply ability is 500 - 1000 K PCS.



TLC TERMINALS TECHNOLOGY LIMITED



+8615338876153



joe@t-terminals.com



cableslugs.com

4B Huafeng Industrial Park Baolong 1 Road Baolong Street, Longgang District, Shenzhen City