

## 16-630mm<sup>2</sup> Mechanical Cable Lugs Two Holes Copper Tube Lugs 2 Holes Connection High Current

### Our Product Introduction

for more products please visit us on [cableslugs.com](http://cableslugs.com)

#### Basic Information

- Place of Origin: China
- Brand Name: TLC
- Certification: UL, CUL, CE
- Model Number: DT, HUP
- Minimum Order Quantity: 1000
- Price: USD
- Packaging Details: PE bag, Carton
- Delivery Time: 5-30 working days
- Payment Terms: T/T
- Supply Ability: 300-800K pcs per month



#### Product Specification

- Application: Electrical Connections
- Current Rating: High
- Type: Crimped
- Surface Treatment: Tin Plated
- Color: Silver
- Product Name: Cable Lugs
- Packaging: Bag, Box, Carton
- Material: Copper
- Highlight: 630mm<sup>2</sup> Mechanical Cable Lugs,  
16mm<sup>2</sup> Mechanical Cable Lugs,  
630mm<sup>2</sup> Two Holes Copper Tube Lugs



#### More Images



## Product Description



### Solderless terminals

## COPPER TUBULAR LUGS (Two-holes)

**Material**  
Terminal Body: Copper  
Plating: Tin

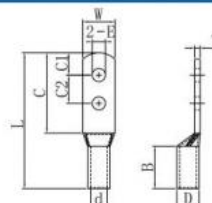

WIRE RANGE	STUD SIZE		ITEM NO	DIMENSION mm											P/N
	mm2 (A.W.G)	Metric		Amerian	E	D	d	W	B	C1	C2	C	L	T	
16 (6)	6	1/4	ST16-6-2H	6.4	8.0	6.0	12.0	11.5	7.1	20.0	34.2	49.0	1.65	T-12101101	
	8	5/16	ST16-8-2H	8.4			13.3		7.5	19.0	34.0		1.5	T-12101102	
25 (4)	6	1/4	ST25-6-2H	6.4	9.5	7.5	14.0	12.0	7.8	20.0	35.6	54.0	2.0	T-12101103	
	8	5/16	ST25-8-2H	8.4			15.7						1.9	T-12101104	
	10	3/8	ST25-10-2H	10.5			1.6						T-12101105		
35 (2)	6	1/4	ST35-6-2H	6.4	11.0	8.4	16.0	13.5	8.0	20.0	36.0	54.0	2.5	T-12101106	
	8	5/16	ST35-8-2H	8.4										T-12101107	
	10	3/8	ST35-10-2H	10.5										T-12101108	
50 (1/0)	6	1/4	ST50-6-2H	6.4	12.5	9.6	18.0	16.0	9.8	25.0	44.6	65.5	2.8	T-12101109	
	8	5/16	ST50-8-2H	8.4										T-12101110	
	10	3/8	ST50-10-2H	10.5										T-12101111	
70 (2/0)	6	1/4	ST70-6-2H	6.4	15.0	12.0	22.0	19.5	11.0	25.0	47.0	74.0	3.0	T-12101112	
	8	5/16	ST70-8-2H	8.4										T-12101113	
	10	3/8	ST70-10-2H	10.5										T-12101114	
	12	1/2	ST70-12-2H	13.0										T-12101115	
95 (3/0)	8	5/16	ST95-8-2H	8.4	17.2	13.6	24.6	20.0	11.6	28.0	51.2	80.0	3.6	T-12101116	
	10	3/8	ST95-10-2H	10.5										T-12101117	
	12	1/2	ST95-12-2H	13.0										T-12101118	
	14	9/16	ST95-14-2H	15.0										T-12101119	
120 (4/0)	10	3/8	ST120-10-2H	10.5	20.0	16.0	29.0	23.0	13.0	32.0	58.0	91.5	3.9	T-12101120	
	12	1/2	ST120-12-2H	13.0										T-12101121	
	14	9/16	ST120-14-2H	15.0										T-12101122	

## COPPER TUBULAR LUGS (Two-holes)

Material  
Terminal Body: Copper  
Plating: Tin

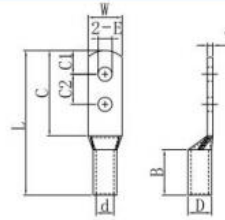

WIRE RANGE	STUD SIZE		ITEM NO	DIMENSION mm										P/N
	mm2 (A.W.G)	Metric	American	E	D	d	W	B	C1	C2	C	L	T	
150 (250/300)	10	3/8	ST150-10-2H	10.5	21.0	16.8	30.0	24.5	15.5	32.0	63.0	98.0	4.1	T-12101123
	12	1/2	ST150-12-2H	13.0										T-12101124
	14	9/16	ST150-14-2H	15.0										T-12101125
185 (300/350)	10	3/8	ST185-10-2H	10.5	23.7	18.7	34.5	30.5	17.0	37.0	71.0	114.5	5.0	T-12101126
	12	1/2	ST185-12-2H	13.0										T-12101127
	14	9/16	ST185-14-2H	15.0										T-12101128
240 (400/450)	12	1/2	ST240-12-2H	13.0	26.0	21.0	37.5	35.0	18.7	45.0	82.4	133.0	5.0	T-12101129
	14	9/16	ST240-14-2H	15.0										T-12101130
	16	5/8	ST240-16-2H	17.0										T-12101131
300 (500)	12	1/2	ST300-12-2H	13.0	30.7	23.7	44.0	41.0	21.0	50.0	92.0	148.5	6.8	T-12101132
	14	9/16	ST300-14-2H	15.0										T-12101133
	16	5/8	ST300-16-2H	17.0										T-12101134
400 (600/750)	12	1/2	ST400-12-2H	13.0	36.0	28.0	51.0	42.5	19.0	62.0	100.0	160.0	8.0	T-12101135
	14	9/16	ST400-14-2H	15.0										T-12101136
	16	5/8	ST400-16-2H	17.0										T-12101137
500 (800/1000)	14	9/16	ST500-14-2H	15.0	39.0	30.0	56.0	51.0	23.5	55.0	101.5	170.5	9.0	T-12101138
	16	5/8	ST500-16-2H	17.0										T-12101139
	20	3/4	ST500-20-2H	21.0										T-12101140
630 (1000/1250)	14	9/16	ST630-14-2H	15.0	45.0	35.0	65.0	56.0	27.0	72.0	126.0	206.0	10.0	T-12101141
	16	5/8	ST630-16-2H	17.0										T-12101142
	20	3/4	ST630-20-2H	21.0										T-12101143

### Product Description:

Lugs terminals are essential components in electrical systems. They guarantee secure and reliable connections between wires or cables and electrical devices or equipment. It is of great importance to properly install lugs terminals for optimal electrical performance and safety.

### Features:

The combination of lugs and terminals ensures a strong and robust electrical connection. This is extremely important to guarantee the smooth transfer of electrical power or signals between various devices. By properly installing lugs and terminals, one can effectively avert potential loose connections, which can result in subpar performance, excessive heating or even electrical failures.

### Applications:

Lugs terminals are essential and pivotal components for electrical systems. They serve the purpose of connecting wires or cables to various electrical devices or equipment.

Most commonly, lugs are shaped as small metal connectors, which are then crimped or soldered onto the ends of the wires. Design thoroughly in mind, they offer a firm and reliable connection with the terminals.

Coming in various sizes and forms, lugs definitely meet different needs of different wire gauges and terminal types.

### Support and Services:

Mechanical Cable Lugs Technical Support and Service

Mechanical cable lugs are an important element of many electrical installations. We provide a comprehensive range of technical support and services for mechanical cable lugs to ensure that your electrical project is successful.

We have a team of experienced engineers on hand to provide technical advice and guidance on the selection and installation of mechanical cable lugs.

We provide detailed installation instructions for mechanical cable lugs, including diagrams and step-by-step instructions.

We also offer after-sales service for mechanical cable lugs, including troubleshooting and repairs.

We have a wide variety of spare parts for mechanical cable lugs, so you can be sure that your installation is running smoothly.

At XYZ, we are committed to providing the highest quality technical support and service for mechanical cable lugs. Our experienced team of engineers is always available to provide you with the best advice and guidance to ensure that your electrical project is a success.

## Packing and Shipping:

### Packaging and Shipping of Mechanical Cable Lugs

Mechanical cable lugs are typically packaged in plastic bags or boxes and are shipped in standard boxes. The packaging material used should be strong enough to protect the product from damage during transportation. It should also be able to resist moisture and other environmental factors. The size of the box should be adequate to securely contain the product and prevent it from moving around during transit. The boxes should also be clearly labelled with the product name and specifications.

When shipping mechanical cable lugs, it is important to use a reliable carrier. The carrier should have a good track record of delivering products safely and on time. Additionally, they should have the necessary expertise and resources to ensure the safe and secure delivery of the product. It is also important to ensure that all necessary paperwork is filled out correctly and that the product is properly insured.

## FAQ:

### Q&A for Mechanical Cable Lugs

**Q: What is the brand name of Mechanical Cable Lugs?**

A: The brand name is TLC.

**Q: What are the model numbers of Mechanical Cable Lugs?**

A: The model numbers are DT and HUP.

**Q: Where is Mechanical Cable Lugs made?**

A: The Mechanical Cable Lugs are made in China.

**Q: What certifications does Mechanical Cable Lugs have?**

A: The certifications are UL, CUL, and CE.

**Q: What is the minimum order quantity of Mechanical Cable Lugs?**

A: The minimum order quantity is 1000 units.

**Q: How much do Mechanical Cable Lugs cost?**

A: The price is in USD.

**Q: How is Mechanical Cable Lugs packaged?**

A: The packaging is PE bag and carton.

**Q: How long does it take to deliver Mechanical Cable Lugs?**

A: The delivery time is 5-30 working days.

**Q: What payment terms are available for Mechanical Cable Lugs?**

A: The payment terms are T/T.

**Q: How many Mechanical Cable Lugs can be supplied per month?**

A: The supply ability is 300-800K pcs per month.



**TLC TERMINALS TECHNOLOGY LIMITED**



+8615338876153



joe@t-terminals.com



cableslugs.com

4B Huafeng Industrial Park Baolong 1 Road Baolong Street, Longgang District, Shenzhen City