

10-185mm² Tin Plated Lugs Cable For Electrical Connection Terminal Lugs Tube Lugs 45D

Our Product Introduction

for more products please visit us on cableslugs.com

Basic Information

- Place of Origin: China
- Brand Name: TLC
- Model Number: T
- Minimum Order Quantity: 1000 pcs
- Price: USD
- Packaging Details: Carton
- Delivery Time: 5-30 days
- Payment Terms: T/T
- Supply Ability: 1KK PCS per month



Product Specification

- Temperature Range: -40 ~+105
- Material: Copper
- Color: Silver
- Cable Range: 10-185mm²
- Tin Plated: Yes
- Highlight: **185mm² Tin Plated terminal lug copper tlc,
terminal lug copper 10mm²,
Electrical cable connector lug 45D tlc**

Product Description



Non- Insulated - Copper Lugs

T45° LUGS TERMINALS

Material
Terminal Body: Copper
Plating: Tin

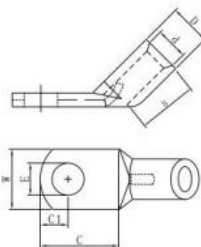

WIRE RANGE	STUD SIZE		ITEM NO	DIMENSION mm(inch)							P/N	QTY BOX
	mm ² (A.W.G.)	Metric		E	D	d	W	B	C	C1		
10 (8)	4	#8	T10-4-45D	4.3	6.9	4.7	11.9	10.0	12.0	5.5	T-12097501	200
	5	#10	T10-5-45D	5.3					12.5		T-12097502	
	6	1/4	T10-6-45D	6.4					13.5		T-12097503	
	8	5/16	T10-8-45D	8.3					15.5		T-12097504	
16 (6)	4	#8	T16-4-45D	4.3	7.8	5.6	12.0	11.0	12.0	5.5	T-12097505	200
	5	#10	T16-5-45D	5.3					12.5		T-12097506	
	6	1/4	T16-6-45D	6.4					13.5		T-12097507	
	8	5/16	T16-8-45D	8.3					15.5		T-12097508	
25 (4)	5	#10	T25-5-45D	5.3	9.5	7.1	14.0	13.0	16.0	6.8	T-12097509	100
	6	1/4	T25-6-45D	6.4					16.0		T-12097510	
	8	5/16	T25-8-45D	8.3					19.0		T-12097511	
	10	3/8	T25-10-45D	10.5					22.0		T-12097512	
35 (2)	6	1/4	T35-6-45D	6.4	11.0	8.2	16.5	16.0	18.0	8.5	T-12097513	100
	8	5/16	T35-8-45D	8.3					22.0		T-12097514	
	10	3/8	T35-10-45D	10.5					22.0		T-12097515	
50 (1/0)	6	1/4	T50-6-45D	6.4	12.5	9.5	18.0	19.0	19.0	8.5	T-12097516	50
	8	5/16	T50-8-45D	8.3					22.0		T-12097517	
	10	3/8	T50-10-45D	10.5					22.0		T-12097518	
	12	1/2	T50-12-45D	13.0					22.0		T-12097519	
	6	1/4	T50-6XK-45D	6.4	13.5	10.5				8.5	T-12097520	
	8	5/16	T50-8XK-45DL	8.3							T-12097521	

TLC TERMINALS INC.
Terminals

143

Product Description:

Cable Lugs are essential components in electrical systems, playing a crucial role in connecting wires or cables to various electrical devices or equipment.

Tube Lugs are small metal connectors that are crimped or soldered onto the ends of wires. These provide a secure and reliable connection to terminals, and come in various sizes and shapes to accommodate different wire gauges and terminal types.

Applications:

Tubular Cable Lugs – Professional Connector for Your Cables

Tubular cable lugs, also known as terminal lugs, are essential for connecting cables in a secure and reliable manner, and these lugs are available in a variety of shapes, sizes, and materials. TLC, a renowned Chinese manufacturer, offers the highest quality copper tube lug, tailored to meet diverse requirements of customers.

TLC TLK – The Ultimate Choice for Your Electrical Connections

TLC TLK is a type of tubular cable lug, specially designed for electrical connections. This product has a minimum order quantity of 1000 pieces, and it is packed in cartons for secure delivery. It has a temperature range of -40 ~ +105, and its size is 10mm². It has a silver color and is made of copper material, suitable for cables of 2.5-10mm².

Choose TLC TLK for your electrical connections and you will be sure of having a secure and reliable connection. With its superior features, TLC TLK is the ultimate choice for your electrical connections.

Customization:

Tubular Cable Lugs from TLC with model number **TLK** is a reliable wire lug terminal with excellent performance. The lugs are made from copper with a tin plated finish in silver color, and with temperature range of -40 ~+105 . The cable range for the Tubular cable lugs is 2.5-10mm². It is manufactured in China with a minimum order quantity of 1000 pcs, and it is packed in cartons. Delivery time is 5-30 days.

Support and Services:

Technical Support and Service for Tubular Cable Lugs

We provide professional technical support and service for our Tubular Cable Lugs. Our experienced engineers provide solutions to all your questions and concerns about our products. We provide comprehensive product information and technical support tailored to your specific requirements. We use the latest technologies to ensure that our products meet the highest standards of quality and performance. We offer on-site installation services and customer-oriented maintenance services. Our technicians will help you understand how to use our products and make the most of them. We also provide a range of after sales services such as troubleshooting, repair, and replacement. We are committed to providing the best possible customer experience for our customers. We are always available to answer any questions or provide assistance. If you have any questions or need help with our products, please feel free to contact us.

Packing and Shipping:

Tubular Cable Lugs are packaged in high-density polyethylene (HDPE) bags. Each bag contains the exact number of lugs for a specific application, and each bag is clearly labeled with the part number, quantity, and other relevant information. All bags are then placed in shipping boxes, which are labeled with the part number, quantity, and destination address. The boxes are then placed on wooden pallets and wrapped with heavy-duty plastic sheeting. The pallets are then loaded onto a truck or container for shipment. The driver or shipper is provided with a packing list that states the exact number and type of lugs being shipped. The packing list is also used to track the shipment and ensure that all lugs are received at their destination.

FAQ:

Q: What is the brand name of Tubular Cable Lugs?

A: The brand name of Tubular Cable Lugs is TLC.

Q: What is the model number of Tubular Cable Lugs?

A: The model number of Tubular Cable Lugs is TLK.

Q: Where are Tubular Cable Lugs made?

A: Tubular Cable Lugs are made in China.

Q: What is the minimum order quantity of Tubular Cable Lugs?

A: The minimum order quantity of Tubular Cable Lugs is 1000 pcs.

Q: What is the packaging details of Tubular Cable Lugs?

A: The packaging details of Tubular Cable Lugs is Carton.

Q: How long does it take to deliver Tubular Cable Lugs?

A: It takes 5-30 days to deliver Tubular Cable Lugs.



TLC TERMINALS TECHNOLOGY LIMITED



+8615338876153



joe@t-terminals.com



cableslugs.com

4B Huafeng Industrial Park Baolong 1 Road Baolong Street, Longgang District, Shenzhen City