

35-240mm² Copper Tube Terminals For Electrical Connections KRS Non Insulated Tubular Cable Lug

Our Product Introduction

Basic Information

- Place of Origin: China
- Brand Name: TLC
- Certification: UL, CUL, CE
- Model Number: KRS
- Minimum Order Quantity: 1000
- Price: USD
- Packaging Details: bag, carton package
- Delivery Time: 5-30 working days
- Payment Terms: T/T
- Supply Ability: 800K pcs per month



Product Specification

- Material: Copper
- Color: Silver
- Product Name: Copper Tube Terminals
- Package: Carton
- Application: Electrical Connections
- Shape: Round
- Highlight: **35-240mm² Copper Tube Terminal,
Copper Tube Terminals 35-240mm²,
TLC Non Insulated Tubular Cable Lug**



for more products please visit us on cableslugs.com



Non-Insulated - Copper Lugs

TUBULAR LUGS TERMINALS

Material
Terminal Body: Copper
Plating: Tin

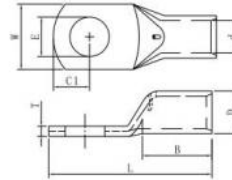

WIRE RANGE	STUD SIZE		ITEM NO	DIMENSION mm(inch)								P/N	QTY BOX
	mm ² (A.W.G)	Metric	Amerian	E	D	d	W	B	C1	L	T		
35 (2)	6	1/4	KRS 35-6	6.4	11.6	9.0	15.0	22.0	9.0	47.0	3.0	T-12095101	100
	8	5/16	KRS 35-8	8.4								T-12095102	
	10	3/8	KRS 35-10	10.5								T-12095103	
50 (1/0)	6	1/4	KRS 50-6	6.4	14.1	11.0	18.0	24.0	10.0	48.5	3.5	T-12095104	
	8	5/16	KRS 50-8	8.4								T-12095105	
	10	3/8	KRS 50-10	10.5								T-12095106	
70 (2/0)	6	1/4	KRS 70-6	6.4	16.6	13.0	20.0	27.0	11.6	56.5	4.0	T-12095107	
	8	5/16	KRS 70-8	8.4								T-12095108	
	10	3/8	KRS 70-10	10.5								T-12095109	
95 (3/0)	8	5/16	KRS 95-8	8.4	19.6	15.0	24.0	30.0	14.5	68.5	5.0	T-12095110	
	10	3/8	KRS 95-10	10.5								T-12095111	
	12	1/2	KRS 95-12	13.0								T-12095112	
120 (4/0)	8	5/16	KRS 120-8	8.4	22.0	17.0	26.0	31.5	15.0	72.5	5.6	T-12095113	
	10	3/8	KRS 120-10	10.5								T-12095114	
	12	1/2	KRS 120-12	13.0								T-12095115	
150 (250/300)	10	3/8	KRS 150-10	10.5	24.6	19.0	30.0	37.0	15.0	80.0	6.0	T-12095116	
	12	1/2	KRS 150-12	13.0								T-12095117	
180 (300/500)	10	3/8	KRS 185-10	10.5	27.6	21.0	32.0	42.0	15.0	86.0	7.0	T-12095118	
	12	1/2	KRS 185-12	13.0								T-12095119	
	16	5/8	KRS 185-16	17.0								T-12095120	
240 (400/545)	10	3/8	KRS 240-10	10.5	29.4	22.5	38.0	43.0	17.0	94.5	7.5	T-12095121	
	12	1/2	KRS 240-12	13.0								T-12095122	
	16	5/8	KRS 240-16	17.0								T-12095123	

TLC TERMINALS INC
Terminals

Product Description:

Lugs terminals are critical components for electrical systems. They offer a secure and trustable link between wires, cables and electrical devices/equipment. If installed correctly they can ensure safety and produce the highest electric performance. The installation of lugs terminals is an essential matter; it is vital for the safety and optimal electrical performance. To avoid electric shorts, overloads, etc. the installation process must be taken seriously and with lot of precision.

Features:

Lugs terminals are an important part of electrical systems. It is a vital piece of equipment that connects wires or cables to various electrical devices.

Lugs are essentially metal connectors. They are affixed to the ends of the wires via crimping or soldering. The lugs are carefully designed to offer a reliable and secure connection to terminals. There is a selection of sizes and shapes for different terminal types and wire gauges.

Applications:

A carefully crafted combination of lugs and terminals provides a reliable and robust connection for electrical power or signals transfer

between devices.

The use of lugs and terminals not only guarantees unparalleled electrical flow, but also helps reduce the risks associated with loose connections, which may lead to performance degradation, overheating or even electrical damages.

Support and Services:

Copper Tube Terminals Technical Support and Service

We provide technical support and service for copper tube terminals. Our knowledgeable staff is available to answer any questions you may have about our products and provide assistance in understanding how our products can best meet your needs.

Our technical support team is available to answer any questions you may have about installation, troubleshooting, or any other technical issues. We can provide detailed instructions for installing, maintaining, and troubleshooting our copper tube terminals.

We also provide 24/7 customer service with our customer service team. Our customer service team is available to answer any questions you may have about our products and provide assistance in understanding how our products can best meet your needs.

We are committed to providing our customers with the highest quality products and the best possible customer service. If you have any questions or concerns, please don't hesitate to contact us.

Packing and Shipping:

Packaging and Shipping of Copper Tube Terminals

We package and ship Copper Tube Terminals in sturdy cardboard boxes. Each box contains 25 terminals and is marked with our logo and branding. We use a variety of carriers to ensure that your product arrives safely and on time. We use standard shipping for most orders, and expedited shipping for orders that require faster delivery times.

For international orders, we use a combination of air and ground shipping services. We also offer special services such as customs clearance, duty and tax prepayment, and local delivery.

FAQ:

Q: What is the brand name of the Copper Tube Terminals?

A: The brand name of the Copper Tube Terminals is TLC.

Q: What is the model number of the Copper Tube Terminals?

A: The model number of the Copper Tube Terminals is TYF and T.

Q: Where is the Copper Tube Terminals made?

A: The Copper Tube Terminals are made in China.

Q: What certifications does the Copper Tube Terminals have?

A: The Copper Tube Terminals have UL, CUL and CE certifications.

Q: What is the minimum order quantity for the Copper Tube Terminals?

A: The minimum order quantity for the Copper Tube Terminals is 1000 pcs.



TLC TERMINALS TECHNOLOGY LIMITED



+8615338876153



joe@t-terminals.com



cableslugs.com

4B Huafeng Industrial Park Baolong 1 Road Baolong Street, Longgang District, Shenzhen City