

38-300mm² Crimped Terminal Lugs Copper CL-H COPPER TUBE TERMINALS NON-INSULATED

Our Product Introduction

Basic Information

- Place of Origin: China
- Brand Name: TLC
- Certification: UL, CUL, CE
- Model Number: CL
- Minimum Order Quantity: 1000
- Price: USD
- Packaging Details: PE bag, Carton
- Delivery Time: 5-30 working days
- Payment Terms: T/T
- Supply Ability: 300-800K pcs per month



Product Specification

- Current Rating: High
- Surface Treatment: Tin Plated
- Product Name: Cable Lugs
- Color: Silver
- Application: Electrical Connections
- MOQ: 1000 Pieces
- Packaging: Bag, Box, Carton
- Material: Copper
- Highlight: **300mm² Crimp Terminal Lugs,
Terminal Lug Copper 300mm²,
38mm² Crimp Terminal Lugs**



Product Description



Non-Insulated - Copper Lugs

CL-H COPPER TUBE TERMINALS

Material
Terminal Body: Copper
Plating: Tin

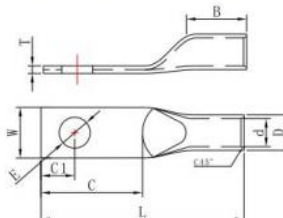

WIRE RANGE	STUD SIZE		ITEM NO	DIMENSION mm								P/N	QTY BOX	
	mm2 (A.W.G.)	Metric		American	E	D	d	W	B	L	C			C1
38 (2)	12	1/2"	CL38-H-12	13.0	12.5	9.5	18.5	32.0	64.0	22.5	10.0	3.0	T-12110001	100
60 (1/0)	12	1/2"	CL60-H-12		14.0	10.5	20.0	36.0	70.0	23.5		3.5	T-12110002	
100 (4/0)	12	1/2"	CL100-H-12		18.0	14.0	26.0	38.0	75.0	26.8	13.0	4.0	T-12110003	
125 (4/0)	12	1/2"	CL125-H-12		20.0	16.0	29.0	40.0	84.5	33.0		3.8	T-12110004	
150 (250/300)	12	1/2"	CL150-H-12		22.0	17.0	31.5	46.0	94.5	32.0	15.0	4.9	T-12110005	
240 (400)	12	1/2"	CL200-H-12		26.0	20.0	37.0	49.0	103.0	35.0	16.0	6.0	T-12110006	
240 (400)	12	1/2"	CL250-H-12		28.0	22.0	40.5	46.0	114.0	41.0	18.0	6.0	T-12110007	
300 (600)	12	1/2"	CL325-H-12		32.0	25.0	46.0	46.0	118.0	49.0	20.0	7.2	T-12110008	

TLC TERMINALS INC
Terminals

127

Product Description:

Lugs terminals are essential components in electrical systems which provide connection between wires or cables and electrical devices or equipment.

Their investment is compulsory for obtaining optimal electrical performance and safety.

Proper installation of lugs terminals is paramount for achieving optimal performance and safe usage.

Features:

The combination of lugs and terminals is indispensable for establishing a secure and sturdy electricity link. It is an indispensable requirement for making sure a efficient transmission of electricity or signals among instruments. In addition, when put in effectively, lugs and terminals can effectively stop unreliable links, that could result in incomplete performance, overheating, or even electric malfunctions.

Applications:

Lugs terminals are essential components in electrical systems, as they play a crucial role in connecting wires or cables to various electrical devices or equipment.

They are small metal connectors that can be crimped or soldered onto the end of wires, and are designed to provide a secure and reliable connection to terminals.

Depending on the application, lugs come in a variety of sizes and shapes to accommodate different wire gauges and terminal types.

Support and Services:

Technical Support and Service for Mechanical Cable Lugs

Mechanical cable lugs offer a secure connection for electrical cables. We provide technical support and services for mechanical cable lugs to ensure their products are always up to date and functioning properly.

Installation

We offer comprehensive instructions and diagrams on the proper installation of mechanical cable lugs. We provide technical advice on the best methods for installation and maintenance of the product.

Replacement Parts

We offer replacement parts for mechanical cable lugs, such as nuts, bolts and washers. We also provide technical advice on the best parts to use for each specific application.

Inspections and Troubleshooting

Our technical team can provide inspections and troubleshooting for mechanical cable lugs. We can examine the product for any signs of wear and tear and offer advice on how to resolve any issues that may arise.

Product Warranties

We provide product warranties for all mechanical cable lugs. Our warranties cover the product against any defects and malfunctions. We also provide technical assistance to ensure the product is functioning correctly.

Packing and Shipping:

Packaging and Shipping for Mechanical Cable Lugs

Mechanical Cable Lugs are typically packaged in plastic bags or boxes, depending on the size and number of items in the order. The items are then placed in corrugated cardboard boxes for shipping. The boxes are secured and an outer carton is placed around the boxes.

The boxes are then shipped via the customer's chosen method of delivery, such as UPS, Federal Express, or USPS. All shipments of Mechanical Cable Lugs are insured against loss or damage, and the customer is provided with tracking information as soon as the shipment is processed.

FAQ:

Q: What is the brand name of the Mechanical Cable Lugs?

A: The brand name of the Mechanical Cable Lugs is TLC.

Q: What is the model number of the Mechanical Cable Lugs?

A: The model number of the Mechanical Cable Lugs is DT and HUP.

Q: Where is the Mechanical Cable Lugs produced?

A: The Mechanical Cable Lugs is produced in China.

Q: What certifications do the Mechanical Cable Lugs have?

A: The Mechanical Cable Lugs have UL, CUL and CE certifications.

Q: What is the minimum order quantity for the Mechanical Cable Lugs?

A: The minimum order quantity for the Mechanical Cable Lugs is 1000 pcs.



TLC TERMINALS TECHNOLOGY LIMITED



+8615338876153



joe@t-terminals.com



cableslugs.com

4B Huafeng Industrial Park Baolong 1 Road Baolong Street, Longgang District, Shenzhen City