

## 6-25mm<sup>2</sup> Tin Plated Lugs Cable For Electrical Wiring And Connecting Tube Cable Lugs Terminal Lugs

Our Product Introduction

for more products please visit us on [cableslugs.com](http://cableslugs.com)

### Basic Information

- Place of Origin: China
- Brand Name: TLC
- Model Number: TLK
- Minimum Order Quantity: 1000 pcs
- Price: USD
- Packaging Details: Carton
- Delivery Time: 5-30 days
- Payment Terms: T/T
- Supply Ability: 1KK PCS per month



### Product Specification

- Cable Range: 5-25mm<sup>2</sup>
- Tin Plated: Yes
- Size: 10mm<sup>2</sup>
- Color: Silver
- Temperature Range: -40 ~+105
- Material: Copper
- Highlight: **TLC 25mm<sup>2</sup> Tin Plated Lugs Cable,  
TLC 25mm<sup>2</sup> Electrical wire cable lugs,  
6mm<sup>2</sup> Tube wire cable lugs**



### Non- Insulated - Copper Lugs

#### TLK LUGS TERMINALS

Material  
Terminal Body: Copper  
Plating: Tin

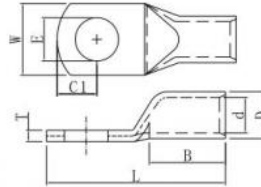

WIRE RANGE	STUD SIZE		ITEM NO	DIMENSION mm(inch)								P/N	QTY BOX
	mm2 (A.W.G)	Metric		E	D	d	W	B	C1	L	T		
6 (12-10)	5	#10	TLK 6-5	5.5	6.5	3.5	10.0	9.0	6.5	27.5	2.4	T-12095401	500
	6	1/4	TLK 6-6	6.5			12.0				1.9	T-12095402	
	8	5/16	TLK 6-8	8.4			15.0				1.5	T-12095403	
	10	3/8	TLK 6-10	10.5			17.0				1.3	T-12095404	
	12	1/2	TLK 6-12	13.0			19.0				1.2	T-12095405	
10 (8)	5	#10	TLK 10-5	5.5	7.0	4.6	12.0	10.0	6.5	28.5	1.8	T-12095406	500
	6	1/4	TLK 10-6	6.5			15.0				1.5	T-12095407	
	8	5/16	TLK 10-8	8.4			17.0				1.3	T-12095408	
	10	3/8	TLK 10-10	10.5			19.0				1.1	T-12095409	
	12	1/2	TLK 10-12	13.0			13.0				1.1	T-12095410	
16 (6)	5	#10	TLK 16-5	5.5	8.5	5.5	12.0	13.0	5.5	31.5	2.8	T-12095411	200
	6	1/4	TLK 16-6	6.5			15.0				2.1	T-12095412	
	8	5/16	TLK 16-8	8.4			17.0				2.0	T-12095413	
	10	3/8	TLK 16-10	10.5			19.0				1.5	T-12095414	
	12	1/2	TLK 16-12	13.0			12.0				1.5	T-12095415	
25 (4)	5	#10	TLK 25-5	5.5	10.0	7.0	14.0	15.0	7.5	37.5	2.8	T-12095416	200
	6	1/4	TLK 25-6	6.5			16.0				2.4	T-12095417	
	8	5/16	TLK 25-8	8.4			18.0				2.2	T-12095418	
	10	3/8	TLK 25-10	10.5			19.0				2.1	T-12095419	
	12	1/2	TLK 25-12	13.0			21.0				1.9	T-12095420	
	12	9/16	TLK 25-14	15.0			14.5				1.9	T-12095421	

## Product Description:

Cable Lugs are essential components in electrical systems since they play an important role in connecting wires or cables to various electrical devices and equipment.

Tube Lugs are small pieces of metal connectors that are crimped or soldered on the ends of the wires. This provides them the ability to form a secure and reliable connection to terminals. They come in different sizes and shapes to fit into different wire gauges and terminal types.

## Applications:

Tubular Cable Lugs, also known as tube lugs, are a kind of cable termination hardware used to connect two different cables. Made of copper, these lugs are available in a range of sizes from 2.5mm<sup>2</sup> to 10mm<sup>2</sup>, with a 10mm<sup>2</sup> size in silver color and tin plated finish. The TLC brand from China offers 1000 pcs of tubular cable lugs with minimum ordering quantity and delivery time of 5 to 30 days. The copper material, silver color, and tin plated finish ensures that the cable lugs are highly resistant to corrosion and have superior electrical conductivity. With these tube lugs crimp connectors, you can easily connect two different cables for a safe and secure connection.

## Customization:

Tubular Cable Lugs

Brand Name: TLC  
Model Number: TLK  
Place of Origin: China  
Minimum Order Quantity: 1000 pcs  
Packaging Details: Carton  
Delivery Time: 5-30 days  
Cable Range: 2.5-10mm<sup>2</sup>  
Temperature Range: -40 ~+105  
Material: Copper  
Tin Plated: Yes  
Size: 10mm<sup>2</sup>

We offer customized services for Tubular Cable Lugs, also known as tube lugs or terminal lugs. These lugs are made of copper and tin plated for a longer lifespan and better protection. They come in various sizes and can support a range of cables from 2.5mm<sup>2</sup> to 10mm<sup>2</sup>. The temperature range is from -40 to +105. We offer a minimum order quantity of 1000 pcs and delivery within 5-30 days.

## Support and Services:

We provide technical support and service for Tubular Cable Lugs. Our customer support team is on hand to answer any questions you may have. We offer a range of services, including:

- Installation and maintenance advice
- Product information and product selection guidance
- Technical troubleshooting and problem resolution
- Technical support over the phone and via email
- On-site support
- Replacement parts and accessories

## Packing and Shipping:

Packaging and Shipping for Tubular Cable Lugs

Tubular cable lugs are supplied in a robust, cardboard carton, with each carton containing 500 pieces of cable lugs. The carton is clearly labelled and sealed with industrial-grade packaging tape to ensure the safety of the product.

Tubular cable lugs can be shipped to any destination in the world. Shipping is carried out using a reliable courier service, ensuring fast and safe delivery at the lowest possible cost.

For orders over a certain amount, free delivery is available. If the customer requires a faster delivery service, they can also choose from an array of express delivery options.

## FAQ:

Q1: What's the Brand Name of the Tubular Cable Lugs?

A1: The Brand Name of the Tubular Cable Lugs is TLC.

Q2: What's the Model Number of the Tubular Cable Lugs?

A2: The Model Number of the Tubular Cable Lugs is TLK.

Q3: Where is the Tubular Cable Lugs made in?

A3: The Tubular Cable Lugs is made in China.

Q4: What is the Minimum Order Quantity of the Tubular Cable Lugs?

A4: The Minimum Order Quantity of the Tubular Cable Lugs is 1000 pcs.

Q5: How would the Tubular Cable Lugs be packed?

A5: The Tubular Cable Lugs would be packed in Carton.



**TLC TERMINALS TECHNOLOGY LIMITED**



+8615338876153



joe@t-terminals.com



cableslugs.com

4B Huafeng Industrial Park Baolong 1 Road Baolong Street, Longgang District, Shenzhen City