

## RoHS Compliant Copper Non Insulated Ring Terminals With Tin Plating 10-50mm<sup>2</sup>

Our Product Introduction

### Basic Information

- Place of Origin: CHINA
- Brand Name: TLC
- Certification: UL, CUL, CE
- Model Number: RNB, DRNB, OT
- Minimum Order Quantity: 1000
- Price: USD
- Packaging Details: Carton
- Delivery Time: 5-30 working days
- Payment Terms: T/T
- Supply Ability: 1KK pcs per month



### Product Specification

- Voltage Rating: 600V
- Insulation: Non-Insulated
- Barrel Type: Closed
- Color: Silver
- RoHS Compliant: Yes
- Product Name: Non Insulated Ring Terminals
- Temperature Rating: 105°C
- Tin Plated: Yes
- Highlight: **RoHS Closed Barrel Ring Terminals,  
RoHS non insulated ring lugs,  
50mm<sup>2</sup> non insulated ring lugs**

for more products please visit us on [cableslugs.com](http://cableslugs.com)



Non-Insulated with Brazed Seam

## OT ROUND TERMINALS

Material  
Terminal Body: Copper  
Plating: Tin

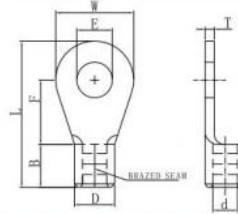

WIRE RANGE	STUD SIZE		ITEM NO	DIMENSION mm								P/N	QTY BOX
	mm2 (A.W.G)	Metric		E	W	d	D	B	F	L	T		
10 (8)	4	#8	OT8-4	4.3					8.5	21.0		T-12093143	1000
	5	#10	OT8-5	5.5	12.0	4.5	7	8.0	9.5	21.0	1.2	T-12093144	
	6	1/4"	OT8-6	6.5					11.5	21.0		T-12093145	
10 (8)	4	#8	OT10-4	4.3	12.0				8.5	23.0		T-12093146	1000
	5	#10	OT10-5	5.5					9.5	25.0		T-12093147	
	6	1/4"	OT10-6	6.5					11.5	27.0		T-12093148	
	8	5/16"	OT10-8	8.5	16.0	5.2	7.6	8.5	13.5	30.0	1.2	T-12093149	
	10	3/8"	OT10-10	10.5	18.0				16.5	34.0		T-12093150	
	12	1/2"	OT10-12	13.0	23.0				19.0	39.5		T-12093151	
16 (6)	4	#8	OT14-4	4.3	12.0				9.5	25.5		T-12093152	500
	5	#10	OT14-5	5.5	12.0					25.5		T-12093153	
	6	1/4"	OT14-6	6.5	12.0					25.5	1.5	T-12093154	
	6	1/4"	OT14-6L	6.5	15.0	6.1	8.7	11.0	13.5	31.0		T-12093155	
	8	5/16"	OT14-8	8.5	15.0				12.5	31.0		T-12093156	
	10	3/8"	OT14-10	10.5	15.0				16.5	31.0		T-12093157	
16 (6)	5	#10	OT16-5	5.5	14.0				9.5	27.0		T-12093158	500
	6	1/4"	OT16-6	6.5	18.0				11.5	31.0		T-12093159	
	8	5/16"	OT16-8	8.5	18.0	6.9	9.9	10.5	12.5	33.0	1.5	T-12093160	
	10	3/8"	OT16-10	10.5	20.0				16.5	37.0		T-12093161	
	12	1/2"	OT16-12	13.0	23.0				19.5	41.5		T-12093162	

## OT ROUND TERMINALS

Material  
Terminal Body: Copper  
Plating: Tin

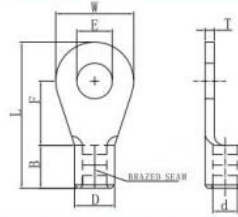

WIRE RANGE	STUD SIZE		ITEM NO	DIMENSION mm								P/N	QTY BOX
	mm2 (A.W.G)	Metric American		E	W	d	D	B	F	L	T		
25 (4)	6	1/4"	OT25-6	6.5	18.0	8.3	11.9	12.0	12.0	33.0	1.8	T-12093163	200
	8	5/16"	OT25-8	8.5	22.0				11.0	37.0		T-12093164	
	10	3/8"	OT25-10	10.5	22.0				17.0	40.0		T-12093165	
	12	1/2"	OT25-12	13.0	24.0				20.0	44.0		T-12093166	
	14	9/16"	OT25-14	15.0	26.0				22.0	47.0		T-12093167	
35 (2)	6	1/4"	OT35-6	6.5	20.0	9.4	13.0	14.0	12.0	36.0	1.5	T-12093168	200
	8	5/16"	OT35-8	8.5	22.0				14.0	39.0		T-12093169	
	10	3/8"	OT35-10	10.5	23.0				17.0	42.5		T-12093170	
	12	1/2"	OT35-12	13.0	25.0				20.0	46.5		T-12093171	
	14	9/16"	OT35-14	15.0	27.0				22.0	49.5		T-12093172	
	16	5/8"	OT35-16	17.0	30.0				25.0	54.0		T-12093173	
50 (1/0)	8	5/16"	OT50-8	8.5	24.0	11.5	15.1	14.0	14.0	40.0	1.6	T-12093174	200
	10	3/8"	OT50-10	10.5	25.0				17.0	43.5		T-12093175	
	2	1/2"	OT50-12	13.0	26.0				20.0	47.0		T-12093176	
	14	9/16"	OT50-14	15.0	28.0				22.0	50.0		T-12093177	
	16	5/8"	OT50-16	17.0	30.0				25.0	45.0		T-12093178	

### Product Description:

Non-insulated terminals are mainly made from conductive materials, such as copper and aluminum, which have great electrical and conductivity properties for guaranteed strong connections.

These connectors are also available in a variety of shapes and sizes, including round, flat, U-shaped, and F-shaped, which makes them ideal for a number of different connections.

Non-insulated terminals can be attached in a range of ways depending on your preferences, including bolting, crimping, and welding the wire.

### Technical Parameters:

Attribute	Value
Product Name	Non Insulated Ring Terminals
Color	Silver
RoHS Compliant	Yes
Tin Plated	Yes
Barrel Type	Closed
Insulation	Non-Insulated
Material	Copper
Voltage Rating	600V

Temperature Rating	105°C
--------------------	-------

## Applications:

Non-insulated terminals are highly versatile components with several different uses. One of their main functions is to securely connect wires together. To do this, the wire is inserted into a hole or notch in the terminal, then secured by bolting, crimping, or welding. This ensures a strong and stable connection between the wire and the other electrical equipment or components, thus allowing the electrical current to flow.

Non-insulated terminals also provide an effective solution for firmly securing wires in place. This is especially important in electronics and the automotive industry, where wires need to be fixed in a specific position to prevent unwanted movement or loosening. These terminals generally have a unique construction, which makes it easy to securely hold the wire in the desired position. For example, U-shaped terminals can clip wires into them and then be secured to the device with bolts or other fixtures.

## Customization:

Non Insulated Ring Terminals

Brand Name: **TLC**

Model Number: **RNB, DRNB, OT**

Place of Origin: **CHINA**

Certification: **UL, CUL, CE**

Minimum Order Quantity: **1000**

Price: **USD**

Packaging Details: **Carton**

Delivery Time: **5-30 working days**

Payment Terms: **T/T**

Supply Ability: **1KK pcs per month**

Barrel Type: **Closed**

Product Name: **Non Insulated Ring Terminals**

Material: **Copper**

Voltage Rating: **600V**

Insulation: **Non-Insulated**

These Non Insulated Ring Terminals are perfect for cable lug ring type, Ring cable lug, and Copper ring lug applications. With TLC's brand name, model numbers RNB, DRNB, and OT, this product has been certified UL, CUL, and CE for safety. The minimum order quantity is 1000 and the price is USD. The packaging is available in carton, and delivery is within 5 to 30 working days. The payment terms are done through T/T, and the supply ability is 1KK pcs per month. The barrel type is closed, and the product name is Non Insulated Ring Terminals, made of copper with a voltage rating of 600V and non-insulated insulation.

## Support and Services:

Non Insulated Ring Terminals provide technical support and services to their customers. Customers can expect to receive quality customer service, technical advice, and support when they purchase Non Insulated Ring Terminals. Technical support includes troubleshooting, installation tips, and compatibility information. Customers can also receive repair services if their Non Insulated Ring Terminals become damaged or malfunction. Additionally, Non Insulated Ring Terminals offers warranties for certain products, so customers can feel confident that their purchase is protected.

## Packing and Shipping:

Packaging and Shipping of Non Insulated Ring Terminals

Non Insulated Ring Terminals are securely packaged in cardboard boxes to protect them from damages during shipping. The size of the boxes depends on the quantity of the terminals and the weight of the shipment. All boxes are marked with contents and addressed labels. We offer various shipping methods, including air freight, express, sea and road freight. The most suitable shipping method is selected depending on the destination and urgency. We aim to deliver the terminals to our customers on time, and with minimum damage.

## FAQ:

Q1: What is Non Insulated Ring Terminals?

A1: Non Insulated Ring Terminals is an electrical connector used for connecting electrical wires or cables.

Q2: What is the Brand Name of Non Insulated Ring Terminals?

A2: The Brand Name of Non Insulated Ring Terminals is TLC.

Q3: What are the Model Numbers of Non Insulated Ring Terminals?

A3: The Model Numbers of Non Insulated Ring Terminals are RNB, DRNB and OT.

Q4: Where is Non Insulated Ring Terminals produced?

A4: Non Insulated Ring Terminals are produced in China.

Q5: What kind of certifications do Non Insulated Ring Terminals have?

A5: Non Insulated Ring Terminals have UL, CUL and CE certifications.



**TLC TERMINALS TECHNOLOGY LIMITED**



+8615338876153



joe@t-terminals.com



cableslugs.com

4B Huafeng Industrial Park Baolong 1 Road Baolong Street, Longgang District, Shenzhen City